

EXISTING CONDITIONS
Herring Brook Road, Eastham

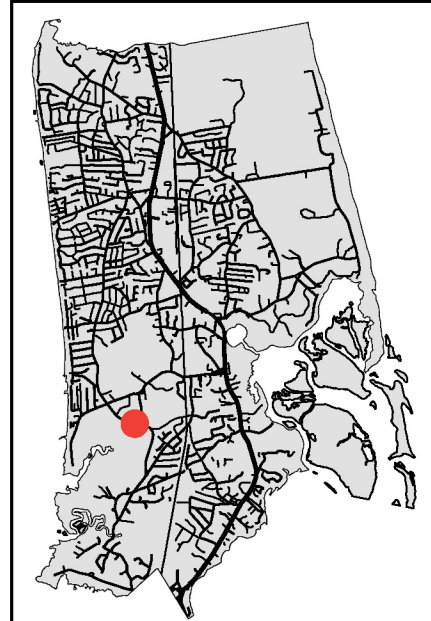
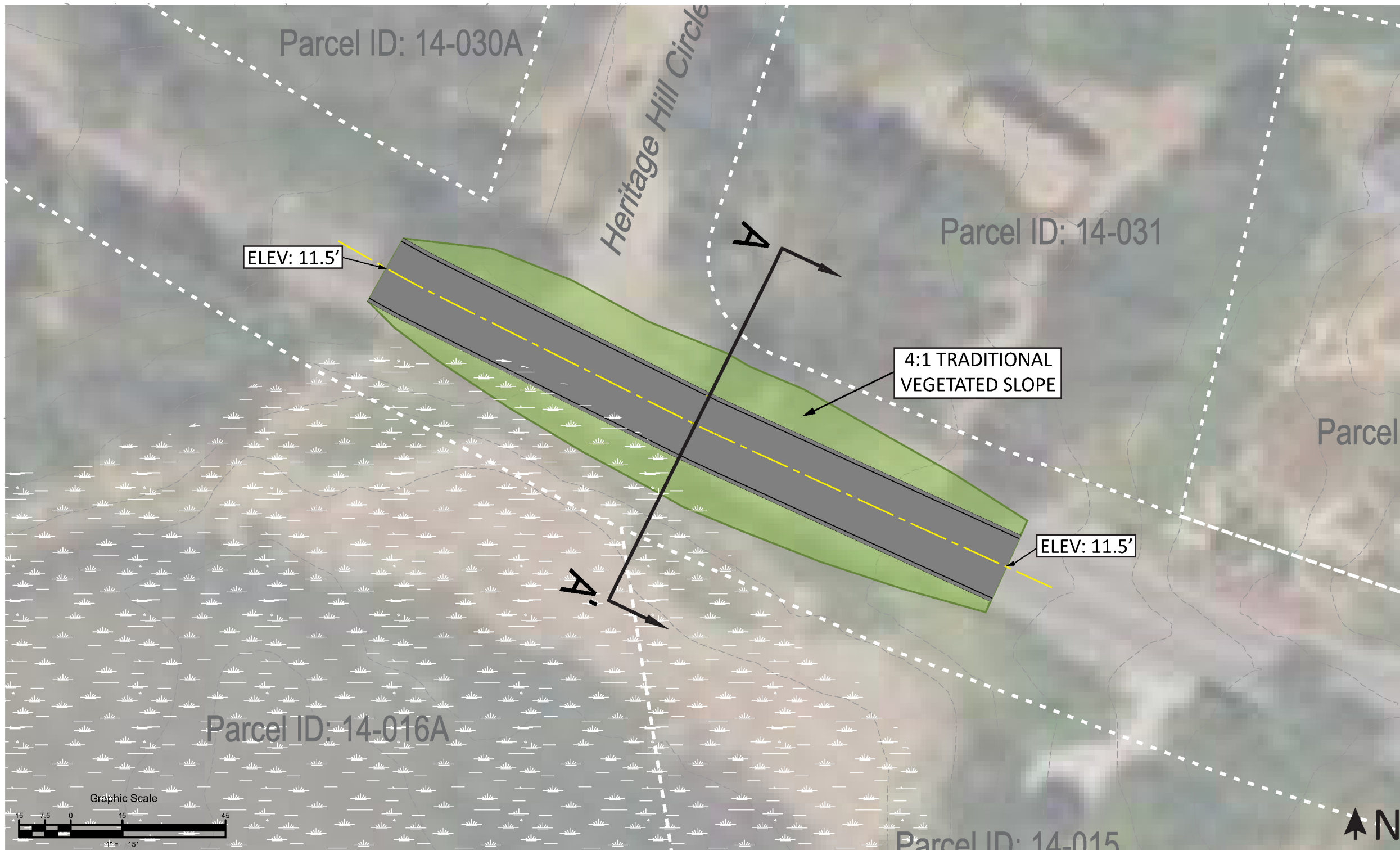

Herring Brook Road
EASTHAM

ALTERNATIVE 1: GRAY

200 linear feet of
Town-owned road are
elevated from a lowest point
of 9.3 feet to a lowest point
of 11.5 feet.

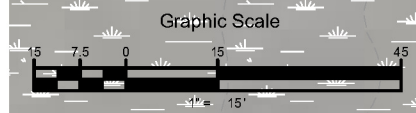

Note: Project overlap with wetland areas, rights of way and property lines is approximate and needs confirmation with a site survey

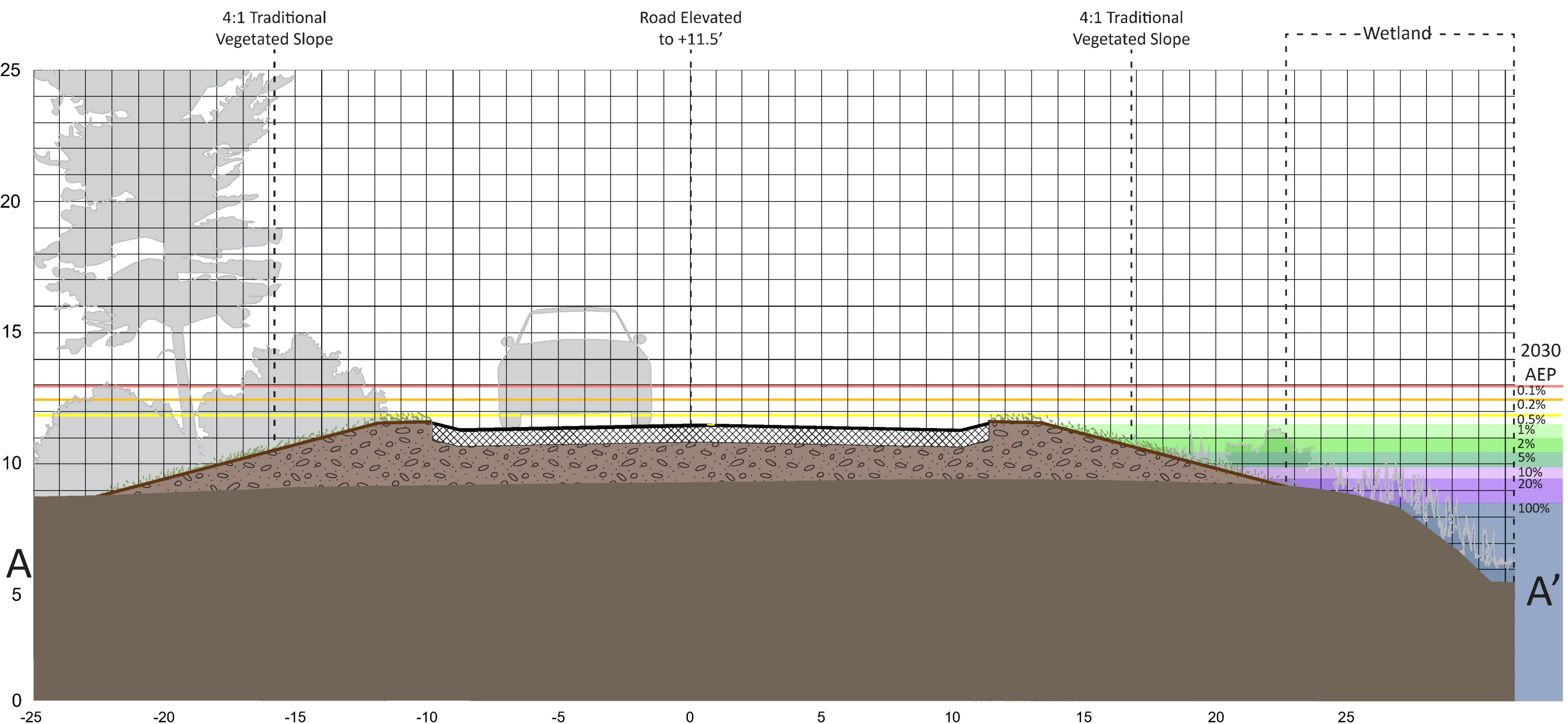

ALTERNATIVE 1: GRAY
 Herring Brook Road, Eastham

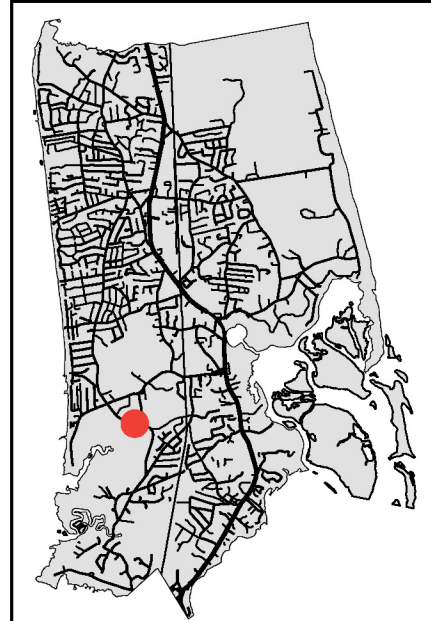
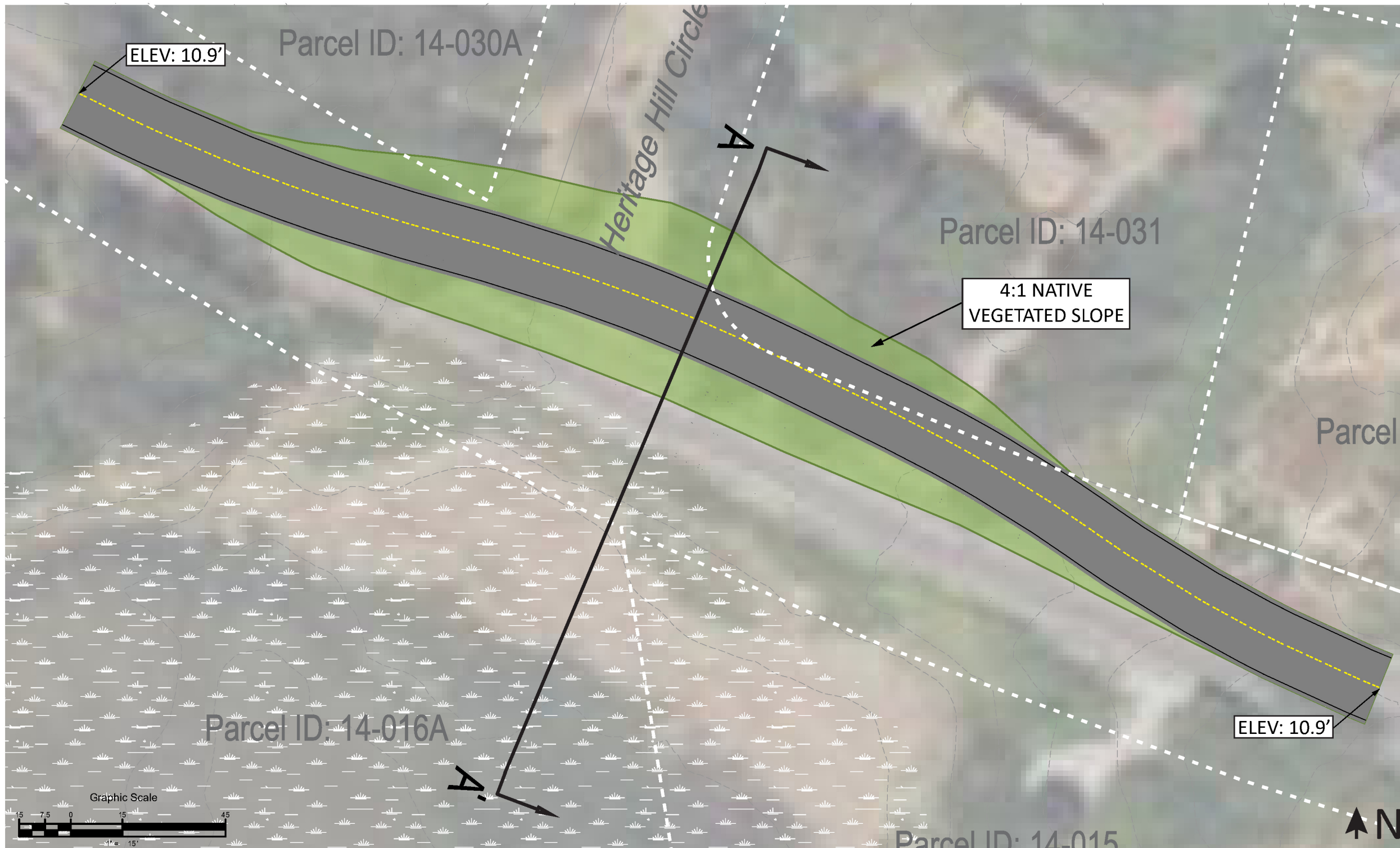

Herring Brook Road
EASTHAM

ALTERNATIVE 2: HYBRID

405 linear feet of Town-owned road are shifted back and elevated from a lowest point of 9.3 feet to a lowest point of 10.9 feet. Wetland impacts are mitigated, but project boundaries intersect with private property.

Note: Project overlap with wetland areas, rights of way and property lines is approximate and needs confirmation with a site survey

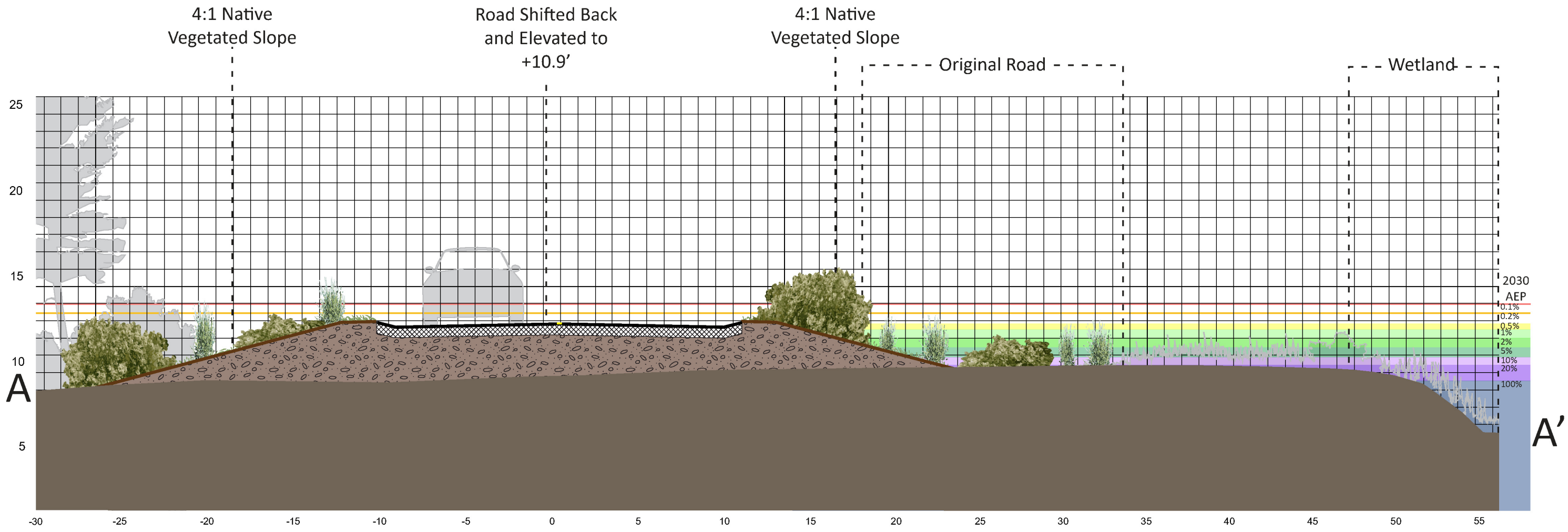

ALTERNATIVE 2: HYBRID
 Herring Brook Road, Eastham

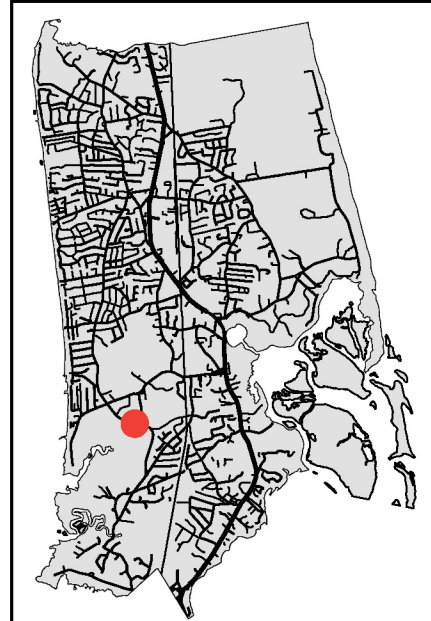
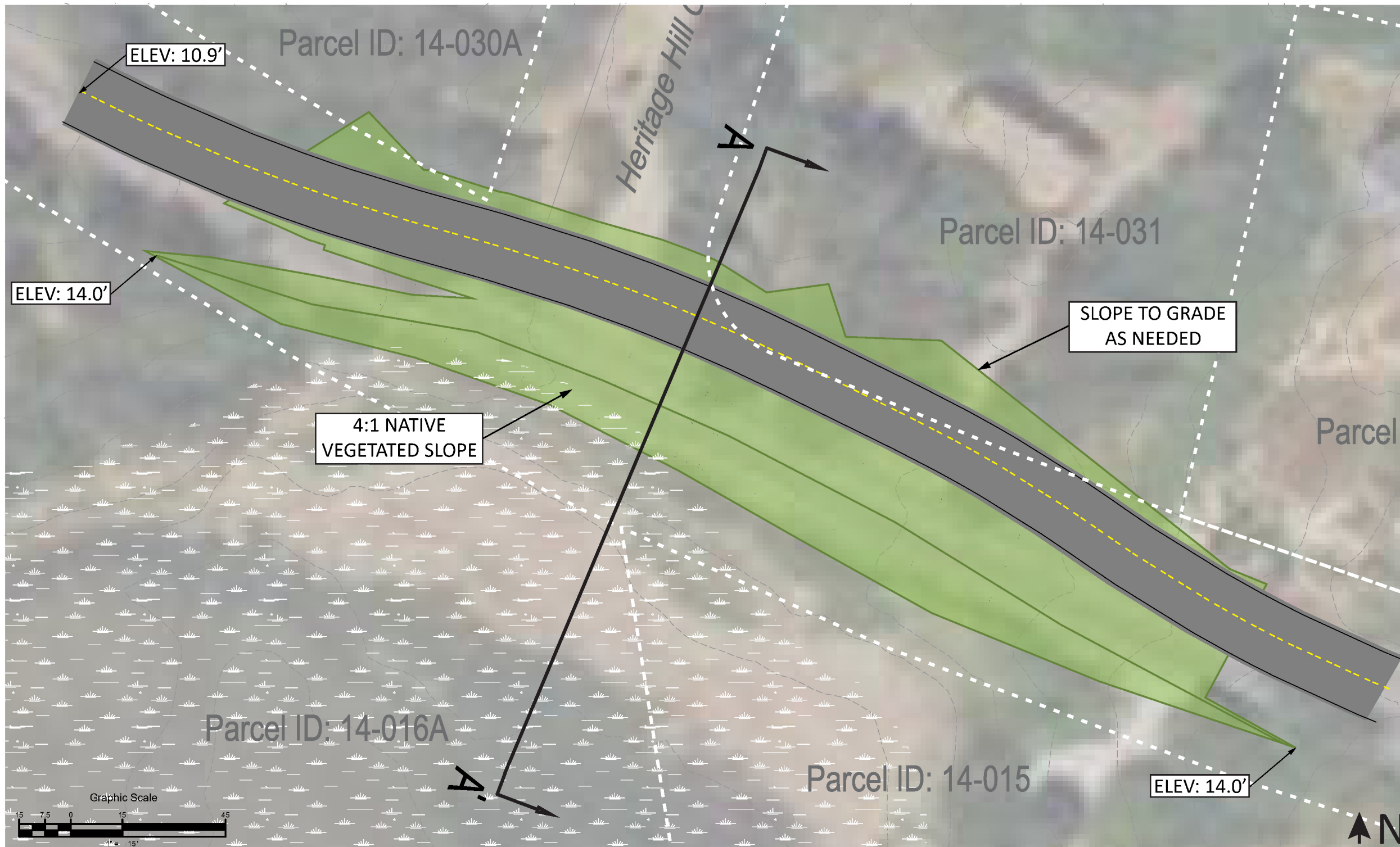

Herring Brook Road
EASTHAM

ALTERNATIVE 3: GREEN

405 linear feet of Town-owned road are shifted back from the water. A berm to 14.0 feet is constructed with a 4:1 slope on the seaward side of the road. Wetland impacts are mitigated, but project boundaries intersect with private property.

Note: Project overlap with wetland areas, rights of way and property lines is approximate and needs confirmation with a site survey

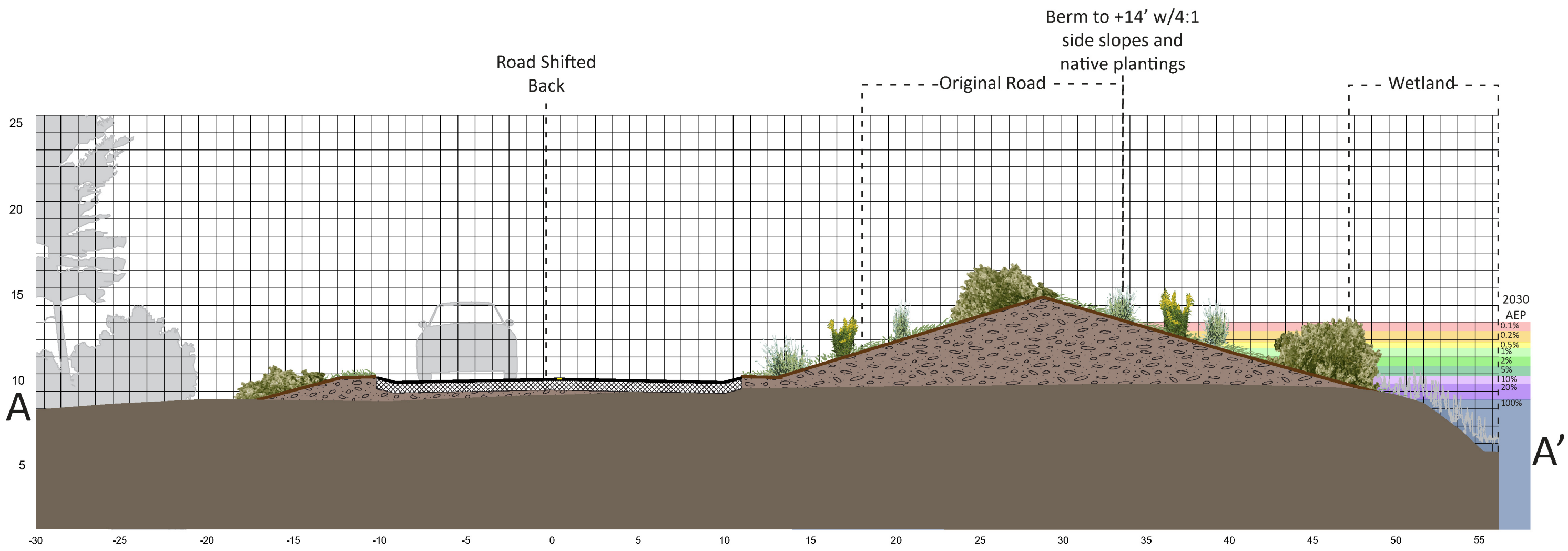

ALTERNATIVE 3: GREEN

Herring Brook Road, Eastham

HERRING BROOK ROAD, EASTHAM

Summary of alternatives

	Description	Critical Elevation	Annual Exceedance Probability			Vulnerable to Tidal Flooding	Impacts to Resource Area(s)	Impacts to Private Property	Estimated Cost*
			2030	2050	2070				
EXISTING	A segment of 20ft wide road with adjacent coastal bank and salt marsh.	9.3 feet	20%	100%	100%	2070	N/A	N/A	N/A
ALTERNATIVE 1: GRAY	200 linear feet of Town-owned road are elevated from a lowest point of 9.3 feet to a lowest point of 11.5 feet.	11.5 feet	1%	10%	100%	N/A	Negative	No	\$96,000
ALTERNATIVE 2: HYBRID	405 linear feet of Town-owned road are shifted back and elevated from a lowest point of 9.3 feet to a lowest point of 10.9 feet. Wetland impacts are mitigated, but project boundaries intersect with private property.	10.9 feet	2%	20%	100%	N/A	None	Yes	\$205,000
ALTERNATIVE 3: GREEN	405 linear feet of Town-owned road are shifted back from the water. A berm to 14.0 feet is constructed with a 4:1 slope on the seaward side of the road. Wetland impacts are mitigated, but project boundaries intersect with private property.	14 feet	0%	1%	5%	N/A	Possible Negative	Yes	\$280,000

*2023 installed material cost +40% escalation (through 2029) and 15% contingency. Excludes design, permitting, mobilization, stormwater and wastewater infrastructure, and site controls. Costs based on experienced contractor opinion and MassDOT costing data.