

NOT FOR CONSTRUCTION

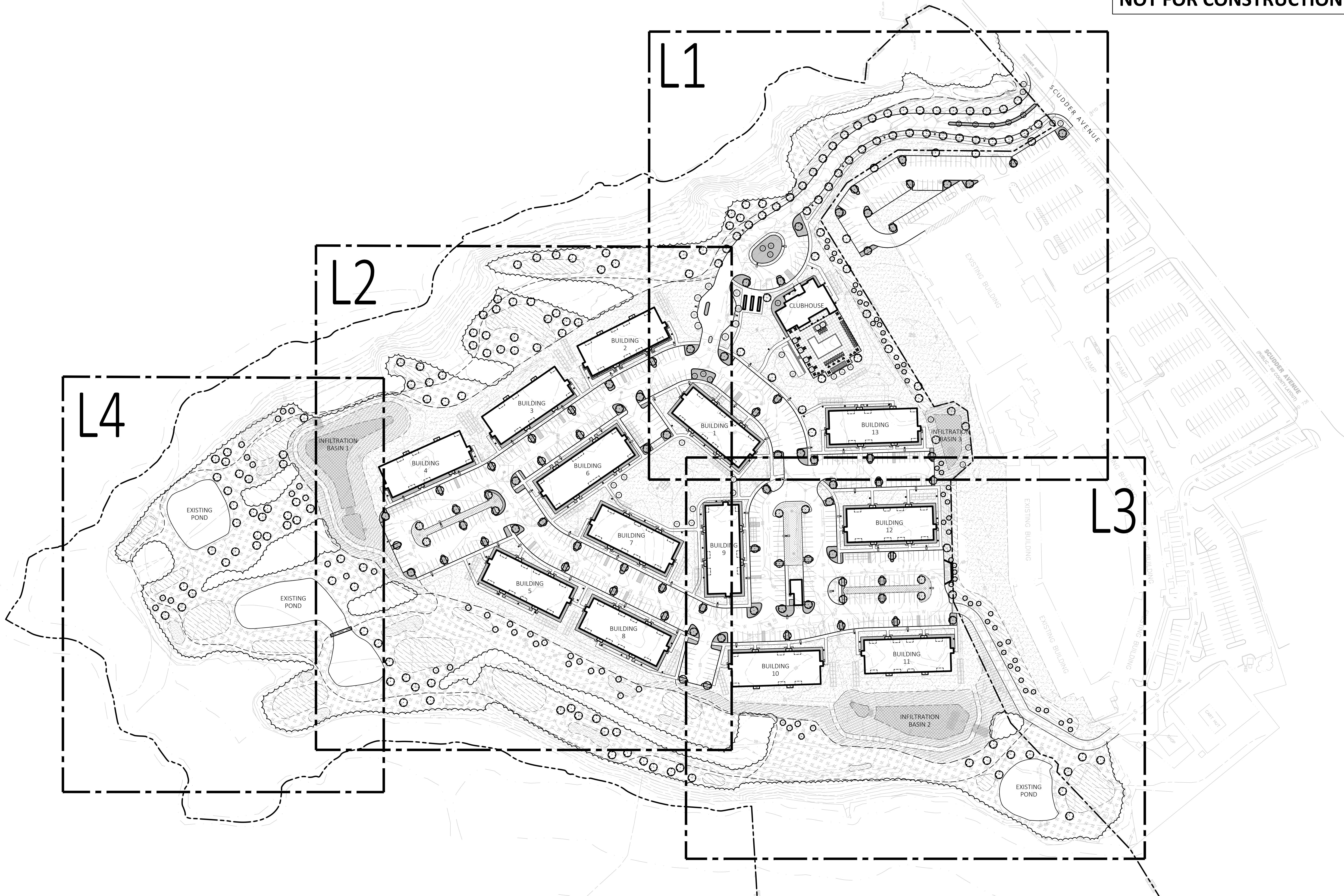

1 LAYOUT KEY PLAN
SCALE: 1" = 80'-0"

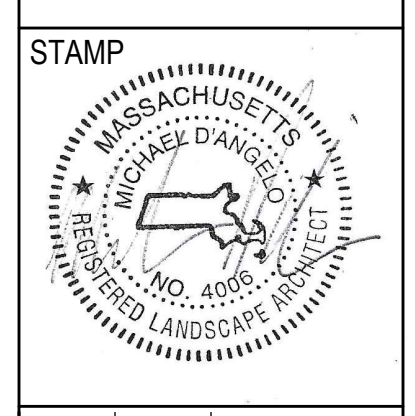
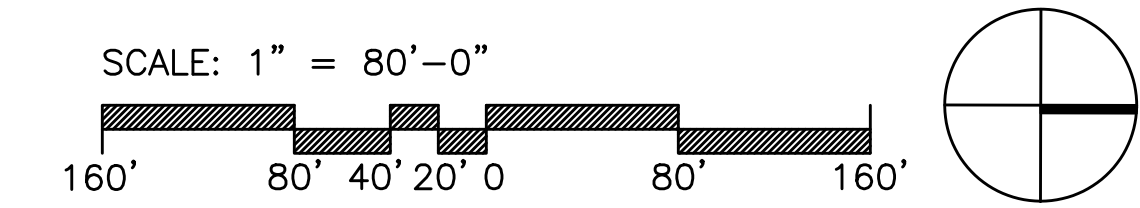

REV. NO.	DATE	DESCRIPTION
1	4/11/21	CDC SUBMITTAL
2	10/21/22	CDC RESUBMITTAL

LAYOUT
KEY
PLAN

DRAWN	LO
CHECKED	
SCALE AS NOTED	
DATE 03/01/21	

NOT FOR CONSTRUCTION

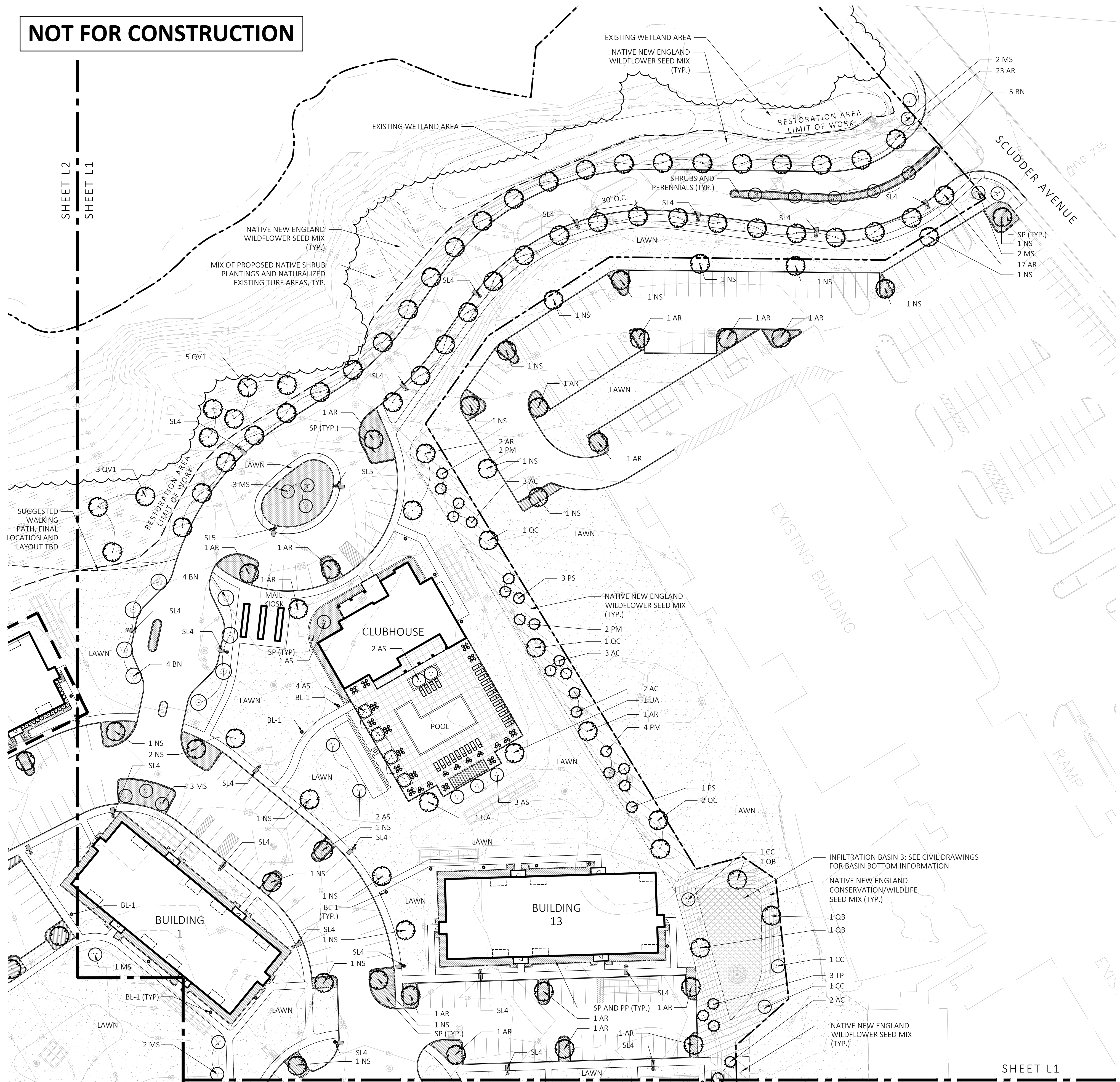

PLANT SCHEDULE - MAIN SITE					
SYMBOL	QTY.	LATIN NAME	COMMON NAME	SIZE	NOTES
SHADE TREES					
AR	72	ACER RUBRUM 'RED SUNSET'	RED SUNSET MAPLE	3"-3.5" CAL.	B&B, 6' CLEAR BRANCHING
GT	17	GLEDITSEA TRICANTHOS 'SKYLINE'	SKYLINE HONEYLOCUST	3"-3.5" CAL.	B&B, 6' CLEAR BRANCHING
NS	39	NYSSA SYLVATICA	BLACK TUPELO	3"-3.5" CAL.	B&B, 6' CLEAR BRANCHING
QB	3	QUERCUS BICOLOR	SWAMP WHITE OAK	3"-3.5" CAL.	B&B, 6' CLEAR BRANCHING
QC	4	QUERCUS COCCINEA	SCARLET OAK	3"-3.5" CAL.	B&B, 6' CLEAR BRANCHING
QO	12	QUERCUS PALUSTRIS	PIN OAK	3"-3.5" CAL.	B&B, 6' CLEAR BRANCHING
UA	2	ULMUS AMERICANA 'PRINCETON'	PRINCETON ELM	3"-3.5" CAL.	B&B, 6' CLEAR BRANCHING
ORNAMENTAL TREES					
AS	12	AMELANCHIER 'AUTUMN BRILLIANCE'	SERVICEBERRY	6-7' TALL	B&B, MULTI-STEM
BN	19	BETULA NIGRA 'HERITAGE'	RIVER BIRCH	10-12' TALL	B&B, MULTI-STEM
CC	3	CERCIS CANADENSIS	EASTERN REDBUD	6-7' TALL	B&B, SINGLE AND MULTI-STEM
MS	13	MAGNOLIA STELLATA	STAR MAGNOLIA	6-7' TALL	B&B, SPECIMEN
EVERGREEN TREES					
AC	10	ABIES CONCOLOR	WHITE FIR	7-8' TALL	B&B
JV	5	JUNIPERUS VIRGINIANA	EASTER RED CEDAR	7-8' TALL	B&B
PM	17	PSEUDOTSUGA MENZIESII	DOUGLAS FIR	7-8' TALL	B&B
PO	4	PICEA GLAUCA	WHITE SPRUCE	7-8' TALL	B&B
PS	10	PINUS STROBUS	WHITE PINE	7-8' TALL	B&B
TP	8	THUJA PLICATA 'GREEN GIANT'	GREEN GIANT ARBORVITAE	7-8' TALL	B&B

SHRUBS PALETTE (SP)					
CA	CLETHRA ALNIFOLIA	SUMMERSWEET	3 GALLON	48" O.C.	B&B
CS	CORNUS SERICEA 'ARCTIC FIRE'	ARCTIC FIRE DOGWOOD	3 GALLON	48" O.C.	B&B
FG	FOTHERGILLA GARDENII	DWARF FOTHERGILLA	3 GALLON	48" O.C.	B&B
HA	HYDRANGEA ARBORESCENS 'ANNABELLE'	ANNABELLE HYDRANGEA	3 GALLON	48" O.C.	B&B
HP	HYDRANGEA PANICULATA 'LITTLE LIME'	LITTLE LIME HYDRANGEA	3 GALLON	48" O.C.	B&B
HQ	HYDRANGEA QUERCIFOLIA	OAKLEAF HYDRANGEA	3 GALLON	48" O.C.	B&B
IG	ILEX GLABRA	INKBERRY	3 GALLON	48" O.C.	B&B
IV	ILEX VERTICILLATA	WINTERBERRY	3 GALLON	48" O.C.	B&B
MP	MYRICA PENNSYLVANICA	NORTHERN BAYBERRY	3 GALLON	48" O.C.	B&B
RA	RHUS AROMATICA 'GRO LOW'	GRO LOW SUMAC	3 GALLON	48" O.C.	B&B
TM	TAXUS X MEDIA 'HICKSII'	HICKS YEW	3 GALLON	48" O.C.	B&B
VA	VACCINIUM ANGUSTIFOLIUM	LOWBUSH BLUEBERRY	3 GALLON	48" O.C.	B&B
VD	VIBURNUM DENTATUM	ARROWWOOD VIBURNUM	5 GALLON	48" O.C.	B&B
PERENNIALS PALETTE (PP)					
AN	ASTER NOVAE 'ANGLIAE'	NEW ENGLAND ASTER	1 GAL	18" O.C.	CONTAINER
DP	DENNSTAEDTIA PUNCTILOBULA	HAYCENTED FERN	1 GAL	18" O.C.	CONTAINER
EP	ECHINACEA PURPUREA	PURPLE CONEFLOWER	1 GAL	18" O.C.	CONTAINER
HD	HEMEROCALLIS 'HAPPY RETURNS'	DAYLILY	1 GAL	18" O.C.	CONTAINER
LD	LEUCANTHEMUM X SUPERBUM 'BECKY'	BECKY DAISY	1 GAL	18" O.C.	CONTAINER
NF	NEPETA X CASSENI 'WALKERS LOW'	CATMINT	1 GAL	18" O.C.	CONTAINER
PL	PEROVSKIA A. 'LITTLE SPIRE'	LITTLE SPIRE RUSSIAN SAGE	1 GAL	18" O.C.	CONTAINER
RF	RUDBECKIA FULGIDA 'GOLDSTURM'	BLACK EYE SUSAN	1 GAL	18" O.C.	CONTAINER
TC	TIARELLA CORDIFOLIA	HEARTLEAF FOAMFLOWER	1 GAL	18" O.C.	CONTAINER
CM	CAREX MORROWII 'ICE DANCE'	JAPANESE SEDGE	1 GAL	18" O.C.	CONTAINER
CP	CAREX PENNSYLVANICA	PENNSYLVANIA SEDGE	1 GAL	18" O.C.	CONTAINER
LS	LIRIOPE SPICATA	LILY TURF	1 GAL	18" O.C.	CONTAINER
PV	PANICUM VIRGATUM 'SHENANDOAH'	SWITCH GRASS	2 GAL	30" O.C.	CONTAINER
SB	SCHIZACHYRIUM SCOPARIUM	LITTLE BLUESTEM	2 GAL	30" O.C.	CONTAINER
PA	PENNISETUM ALOPECUROIDES	FOUNTAIN GRASS	2 GAL	24" O.C.	CONTAINER

BIORETENTION AREA PALETTE					
SHRUBS					
CA	CLETHRA ALNIFOLIA	SWEET PEPPERBUSH	3 GAL	48" O.C.	CONTAINER
CS	CORNUS STOLONIFERA	REDTWIG DOGWOOD	3 GAL	48" O.C.	CONTAINER
IG	ILEX GLABRA	INKBERRY HOLLY	3 GAL	48" O.C.	CONTAINER
IV	ILEX VERTICILLATA	WINTERBERRY HOLLY	3 GAL	48" O.C.	CONTAINER
IT	ITEA VIRGINICA	VIRGINIA SWEETSPICE	3 GAL	48" O.C.	CONTAINER
VC	VACCINIUM CORYBOSUM	HIGHBUSH BLUEBERRY	3 GAL	48" O.C.	CONTAINER
VD	VIBURNUM DENTATUM	ARROWWOOD VIBURNUM	3 GAL	48" O.C.	CONTAINER
PERENNIALS					
AT	ASCLEPIAS TUBEROSA	BUTTERFLY MILKWEED	1 GAL	18" O.C.	CONTAINER
BA	BAPTISIA AUSTRALIS	FALSE BLUE INDIGO	1 GAL	18" O.C.	CONTAINER
EP	ECHINACEA PURPUREA	PURPLE CONEFLOWER	1 GAL	18" O.C.	CONTAINER
EJ	EUPATORIUM PURPUREUM	JOE PYE WEED	1 GAL	18" O.C.	CONTAINER
BF	IRIS VERSICOLOR	BLUE FLAG IRIS	1 GAL	18" O.C.	CONTAINER
LB	LIATRIS LIGULISTYLIS	MEADOW BLAZING STAR	1 GAL	18" O.C.	CONTAINER
RH	RUDBECKIA HIRTA	BLACK EYED SUSAN	1 GAL	18" O.C.	CONTAINER
PS	PANICUM VIRGATUM 'SHENANDOAH'	SWITCHGRASS	1 GAL	18" O.C.	CONTAINER
SS	SCHIZACHYRIUM SCOPARIUM	LITTLE BLUESTEM	1 GAL	18" O.C.	CONTAINER
SN	SYMPHYOTRICHUM NOVAE-ANGLIAE	NEW ENGLAND ASTER	1 GAL	18" O.C.	CONTAINER
TC	TIARELLA CORDIFOLIA	HEARTLEAF FOAMFLOWER	1 GAL	18" O.C.	CONTAINER

MEADOW SEED MIX			
NEW ENGLAND WETLAND PLANTS, INC.	"NEW ENGLAND CONSERVATION / WILDLIFE MIX"	25 LB/ACRE	APPLY COVER CROP; FALL: GRAIN RYE, SPRING: OAT; 800-873-3321; OR APPROVED EQUAL
NEW ENGLAND WETLAND PLANTS, INC.	"NEW ENGLAND WILDFLOWER MIX"	23 LB/ACRE	APPLY COVER CROP; FALL: GRAIN RYE, SPRING: OAT; 800-873-3321; OR APPROVED EQUAL
	INFILTRATION BASIN "BOTTOM"		SEE CIVIL DRAWINGS FOR BASIN BOTTOM INFORMATION

PLANT SCHEDULE - RESTORATION AREA					
SYMBOL	QTY.	LATIN NAME	COMMON NAME	SIZE	NOTES
RESTORATION AREA - SHADE TREES					
AR1	16	ACER RUBRUM	RED MAPLE	1.5"-2" CAL.	B&B, 6' CLEAR BRANCHING
PC1	3	PRUNUS SEROTINA	BLACK CHERRY	1.5"-2" CAL.	B&B, 6' CLEAR BRANCHING
QV1	86	QUERCUS VELUTINA	BLACK OAK	1.5"-2" CAL.	B&B, 6' CLEAR BRANCHING
RESTORATION AREA - EVERGREEN TREES					
PR1	17	PINUS RIGIDA	PITCH PINE	7-8' TALL	B&B
PS1	22	PINUS STROBUS	WHITE PINE	7-8' TALL	B&B
RESTORATION AREA - SHRUBS					
MIX OF PROPOSED NATIVE SHRUBS PLANTINGS AND NATURALIZED EXISTING TURF AREAS. LOCATIONS AND QUANTITIES OF SHRUBS TBD					

*RESTORATION PLANTINGS PROVIDED BY ILEX ENVIRONMENTAL, INC. REFER TO THE "EMBLEM-HYANNIS RESTORATION PLAN" NARRATIVE FOR MORE INFORMATION

LIGHT SCHEDULE						
SYMBOL	LABEL	MODEL	MOUNT	DESCRIPTION	OPTIONS	REP
☐	SL4	HUBBELL - RATIO SERIES RAR2-480L-185-4K7-4W-U	CONCRETE FOOTING; KEEP 24" ABOVE GRADE	SINGLE	COLOR: BLK	ILLUMINATE 617-947-8996 STEVE PRUDHOMME
☐	SL5	HUBBELL - RATIO SERIES RAR2-480L-185-4K7-SQW-U	CONCRETE FOOTING; KEEP 24" ABOVE GRADE	SINGLE	COLOR: BLK	
☐	SL4-2	HUBBELL - RATIO SERIES RAR2-480L-185-4K7-4W-U	CONCRETE FOOTING; KEEP 24" ABOVE GRADE	BACK-BACK	COLOR: BLK	
☉	BL-1	ARLUCE - KLOU-IK180 S-KK0204US-125-0870006D-740-12US	CONCRETE FOOTING; KEEP 3" ABOVE GRADE	SINGLE	COLOR: BLK	

SUBMIT CUT SHEETS FOR APPROVAL; SEE PHOTOMETRIC PLAN PROVIDED WITH THIS DRAWING SET FOR MORE INFORMATION.

1 PLANTING & LIGHTING PLAN
SCALE: 1" = 40'-0"

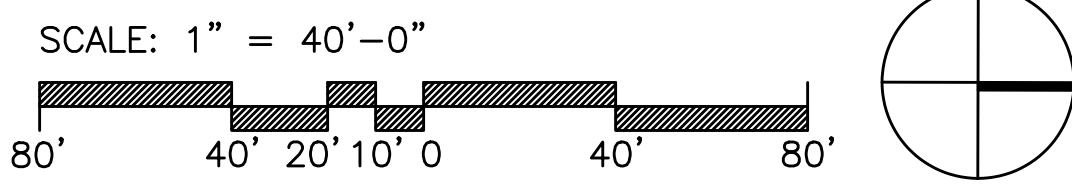

SHEET L1
SHEET L3

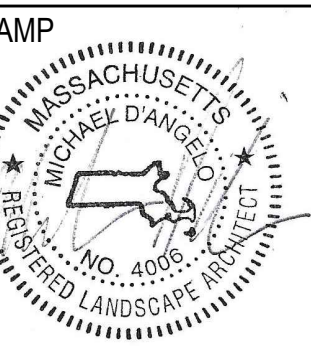

REV. NO.	DATE	DESCRIPTION
1	4/11/21	CCC SUBMITTAL
2	10/21/22	CCC RESUBMITTAL

PLANTING AND LIGHTING PLAN

DRAWN
CHECKED
SCALE AS NOTED
DATE 03/01/21

L1

NOT FOR CONSTRUCTION

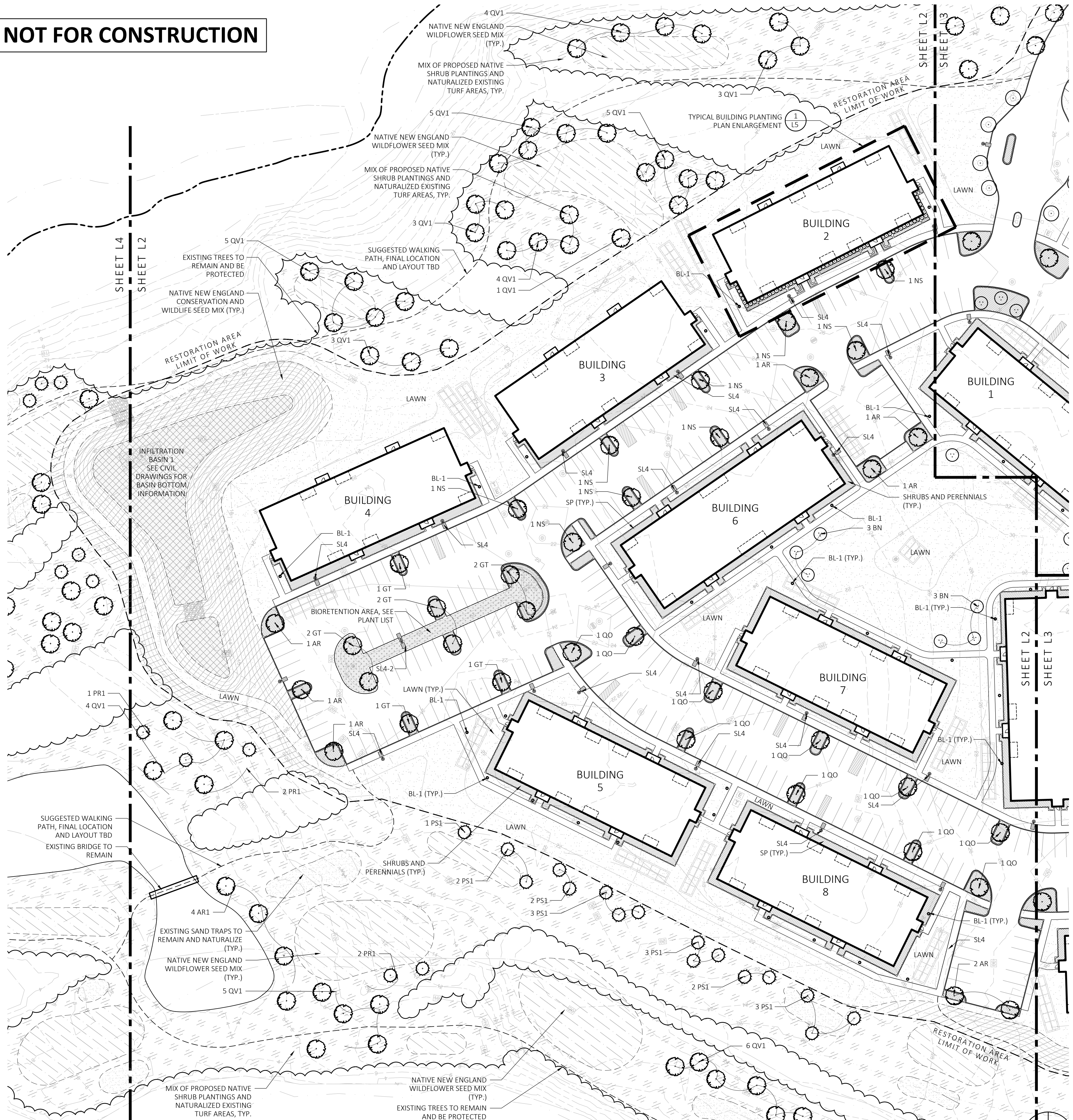

1 PLANTING & LIGHTING PLAN
SCALE: 1" = 40'-0"

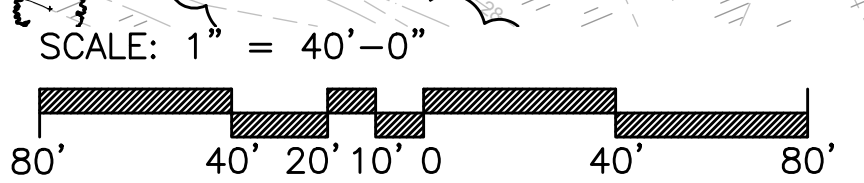

PLANT SCHEDULE - MAIN SITE					
SYMBOL	QTY.	LATIN NAME	COMMON NAME	SIZE	NOTES
SHADE TREES					
AR	72	ACER RUBRUM 'RED SUNSET'	RED SUNSET MAPLE	3"-3.5" CAL.	B&B, 6' CLEAR BRANCHING
GT	17	GLEDITSIA TRICANTHOS 'SKYLINE'	SKYLINE HONEYLOCUST	3"-3.5" CAL.	B&B, 6' CLEAR BRANCHING
NS	39	NYSSA SYLVATICA	BLACK TUPELO	3"-3.5" CAL.	B&B, 6' CLEAR BRANCHING
QB	3	QUERCUS BICOLOR	SWAMP WHITE OAK	3"-3.5" CAL.	B&B, 6' CLEAR BRANCHING
QC	4	QUERCUS COCCINEA	SCARLET OAK	3"-3.5" CAL.	B&B, 6' CLEAR BRANCHING
QO	12	QUERCUS PALustris	PIN OAK	3"-3.5" CAL.	B&B, 6' CLEAR BRANCHING
UA	2	ULMUS AMERICANA 'PRINCETON'	PRINCETON ELM	3"-3.5" CAL.	B&B, 6' CLEAR BRANCHING
ORNAMENTAL TREES					
AS	12	AMELANCHIER 'AUTUMN BRILLIANCE'	SERVICEBERRY	6-7' TALL	B&B, MULTI-STEM
BN	19	BETULA NIGRA 'HERITAGE'	RIVER BIRCH	10-12' TALL	B&B, MULTI-STEM
CC	3	CERCIS CANADENSIS	EASTERN REDBUD	6-7' TALL	B&B, SINGLE AND MULTI-STEM
MS	13	MAGNOLIA STELLATA	STAR MAGNOLIA	6-7' TALL	B&B, SPECIMEN
EVERGREEN TREES					
AC	10	ABIES CONCOLOR	WHITE FIR	7-8' TALL	B&B
JV	5	JUNIPERUS VIRGINIANA	EASTERN RED CEDAR	7-8' TALL	B&B
PM	17	PSEUDOTSUGA MENZIESII	DOUGLAS FIR	7-8' TALL	B&B
PO	4	PICEA GLAUC	WHITE SPRUCE	7-8' TALL	B&B
PS	10	PINUS STROBUS	WHITE PINE	7-8' TALL	B&B
TP	8	THUJA PLICATA 'GREEN GIANT'	GREEN GIANT ARBORVITAE	7-8' TALL	B&B

SHRUBS PALETTE (SP)					
CA	CLETHRA ALNIFOLIA	SUMMERSWEET	3 GALLON	48" O.C. B&B	
CS	CORNUS SERICEA 'ARCTIC FIRE'	ARCTIC FIRE DOGWOOD	3 GALLON	48" O.C. B&B	
FG	FOTHERGILLA GARDENII	DWARF FOTHERGILLA	3 GALLON	48" O.C. B&B	
HA	HYDRANGEA ARBORESCENS 'ANNABELLE'	ANNABELLE HYDRANGEA	3 GALLON	48" O.C. B&B	
HP	HYDRANGEA PANICULATA 'LITTLE LIME'	LITTLE LIME HYDRANGEA	3 GALLON	48" O.C. B&B	
HQ	HYDRANGEA QUERCIFOLIA	OAKLEAF HYDRANGEA	3 GALLON	48" O.C. B&B	
IG	ILEX GLABRA	INKBERRY	3 GALLON	48" O.C. B&B	
IV	ILEX VERTICILLATA	WINTERBERRY	3 GALLON	48" O.C. B&B	
MP	MYRICA PENNSYLVANICA	NORTHERN BAYBERRY	3 GALLON	48" O.C. B&B	
RA	RHUS AROMATICA 'GRO LOW'	GRO LOW SUMAC	3 GALLON	48" O.C. B&B	
TM	TAXUS X MEDIA 'HICKSII'	HICKS YEW	3 GALLON	48" O.C. B&B	
VA	VACCINIUM ANGUSTIFOLIUM	LOWBUSH BLUEBERRY	3 GALLON	48" O.C. B&B	
VD	VIBURNUM DENTATUM	ARROWWOOD VIBURNUM	5 GALLON	48" O.C. B&B	
PERENNIALS PALETTE (PP)					
AN	ASTER NOVAE 'ANGLIAE'	NEW ENGLAND ASTER	1 GAL	18" O.C. CONTAINER	
DP	DENNSTAEDTIA PUNCTILOBULA	HAYCENTED FERN	1 GAL	18" O.C. CONTAINER	
EP	ECHINACEA PURPUREA	PURPLE CONEFLOWER	1 GAL	18" O.C. CONTAINER	
HD	HEMEROCALLIS 'HAPPY RETURNS'	DAYLILY	1 GAL	18" O.C. CONTAINER	
LD	LEUCANTHEMUM X SUPERBUM 'BECKY'	BECKY DAISY	1 GAL	18" O.C. CONTAINER	
NF	NEPETA X CASSINII 'WALKERS LOW'	CATMINT	1 GAL	18" O.C. CONTAINER	
PL	PEROVYSKIA 'LITTLE SPIRE'	LITTLE SPIRE RUSSIAN SAGE	1 GAL	18" O.C. CONTAINER	
RF	RUDBECKIA FULGIDA 'GOLDSTURM'	BLACK EYE SUSAN	1 GAL	18" O.C. CONTAINER	
TC	TIARELLA CORDIFOLIA	HEARTLEAF FOAMFLOWER	1 GAL	18" O.C. CONTAINER	
CM	CAREX MORROWII 'ICE DANCE'	JAPANESE SEDGE	1 GAL	18" O.C. CONTAINER	
CP	CAREX PENNSYLVANICA	PENNSYLVANIA SEDGE	1 GAL	18" O.C. CONTAINER	
LS	LIRIOPE SPICATA	LILY TURF	1 GAL	18" O.C. CONTAINER	
PV	PANICUM VIRGATUM 'SHENANDOAH'	SWITCH GRASS	2 GAL	30" O.C. CONTAINER	
SB	SCHIZACHYRIUM SCOPARIUM	LITTLE BLUESTEM	2 GAL	30" O.C. CONTAINER	
PA	PENNISETUM ALOPECUROIDES	FOUNTAIN GRASS	2 GAL	24" O.C. CONTAINER	

BIORETENTION AREA PALETTE					
SHRUBS					
CA	CLETHRA ALNIFOLIA	SWEET PEPPERBUSH	3 GAL	48" O.C. CONTAINER	
CS	CORNUS STOLONIFERA	REDTWIG DOGWOOD	3 GAL	48" O.C. CONTAINER	
IG	ILEX GLABRA	INKBERRY HOLLY	3 GAL	48" O.C. CONTAINER	
IV	ILEX VERTICILLATA	WINTERBERRY HOLLY	3 GAL	48" O.C. CONTAINER	
IT	ITEA VIRGINICA	VIRGINIA SWEETSPICE	3 GAL	48" O.C. CONTAINER	
VC	VACCINIUM CORYBOSUM	HIGHBUSH BLUEBERRY	3 GAL	48" O.C. CONTAINER	
VD	VIBURNUM DENTATUM	ARROWWOOD VIBURNUM	3 GAL	48" O.C. CONTAINER	
PERENNIALS					
AT	ASCLEPIAS TUBEROSA	BUTTERFLY MILKWEED	1 GAL	18" O.C. CONTAINER	
BA	BAPTISIA AUSTRALIS	FALSE BLUE INDIGO	1 GAL	18" O.C. CONTAINER	
EP	ECHINACEA PURPUREA	PURPLE CONEFLOWER	1 GAL	18" O.C. CONTAINER	
EJ	EUPATORIUM PURPUREUM	JOE PYE WEED	1 GAL	18" O.C. CONTAINER	
BF	IRIS VERSICOLOR	BLUE FLAG IRIS	1 GAL	18" O.C. CONTAINER	
LB	LIATRIS LIGULISTYLIS	MEADOW BLAZING STAR	1 GAL	18" O.C. CONTAINER	
RH	RUDBECKIA HIRTA	BLACK EYED SUSAN	1 GAL	18" O.C. CONTAINER	
PS	PANICUM VIRGATUM 'SHENANDOAH'	SWITCHGRASS	1 GAL	18" O.C. CONTAINER	
SS	SCHIZACHYRIUM SCOPARIUM	LITTLE BLUESTEM	1 GAL	18" O.C. CONTAINER	
SN	SYMPHYOTRICHUM NOVAE-ANGLIAE	NEW ENGLAND ASTER	1 GAL	18" O.C. CONTAINER	
TTC	TIARELLA CORDIFOLIA	HEARTLEAF FOAMFLOWER	1 GAL	18" O.C. CONTAINER	

MEADOW SEED MIX					
NEW ENGLAND WETLAND PLANTS, INC.	"NEW ENGLAND CONSERVATION / WILDLIFE MIX"	25 LB/ACRE	APPLY COVER CROP; FALL: GRAIN RYE, SPRING: OAT; 800-873-3321; OR APPROVED EQUAL		
NEW ENGLAND WETLAND PLANTS, INC.	"NEW ENGLAND WILDFLOWER MIX"	23 LB/ACRE	APPLY COVER CROP; FALL: GRAIN RYE, SPRING: OAT; 800-873-3321; OR APPROVED EQUAL		
	INFILTRATION BASIN "BOTTOM"		SEE CIVIL DRAWINGS FOR BASIN BOTTOM INFORMATION		

PLANT SCHEDULE - RESTORATION AREA					
SYMBOL	QTY.	LATIN NAME	COMMON NAME	SIZE	NOTES
RESTORATION AREA - SHADE TREES					
AR1	16	ACER RUBRUM	RED MAPLE	1.5"-2" CAL.	B&B, 6' CLEAR BRANCHING
PC1	3	PRUNUS SEROTINA	BLACK CHERRY	1.5"-2" CAL.	B&B, 6' CLEAR BRANCHING
QV1	86	QUERCUS VELUTINA	BLACK OAK	1.5"-2" CAL.	B&B, 6' CLEAR BRANCHING
RESTORATION AREA - EVERGREEN TREES					
PR1	17	PINUS RIGIDA	PITCH PINE	7-8' TALL	B&B
PS1	22	PINUS STROBUS	WHITE PINE	7-8' TALL	B&B
RESTORATION AREA - SHRUBS					
MIX OF PROPOSED NATIVE SHRUB PLANTINGS AND NATURALIZED EXISTING TURF AREAS. LOCATIONS AND QUANTITIES OF SHRUBS TBD					

*RESTORATION PLANTINGS PROVIDED BY ILEX ENVIRONMENTAL, INC. REFER TO THE "EMBLEM-HYANNIS RESTORATION PLAN" NARRATIVE FOR MORE INFORMATION

LIGHT SCHEDULE						
SYMBOL	LABEL	MODEL	MOUNT	DESCRIPTION	OPTIONS	REP
☐	SL4	HUBBELL - RATIO SERIES RAR2-480L-185-4K7-4W-U	CONCRETE FOOTING; KEEP 24" ABOVE GRADE	SINGLE	COLOR: BLK	ILLUMINATE 617-947-8996 STEVE PRUDHOMME
☐	SL5	HUBBELL - RATIO SERIES RAR2-480L-185-4K7-5QW-U	CONCRETE FOOTING; KEEP 24" ABOVE GRADE	SINGLE	COLOR: BLK	
☐	SL4-2	HUBBELL - RATIO SERIES RAR2-480L-185-4K7-4W-U	CONCRETE FOOTING; KEEP 24" ABOVE GRADE	BACK-BACK	COLOR: BLK	
☉	BL-1	ARLUCE - KLOU-IK180 S-KK0204US-125-0870006D-740-12US	CONCRETE FOOTING; KEEP 3" ABOVE GRADE	SINGLE	COLOR: BLK	

SUBMIT CUT SHEETS FOR APPROVAL; SEE PHOTOMETRIC PLAN PROVIDED WITH THIS DRAWING SET FOR MORE INFORMATION.

MDLA
MICHAEL D'ANGELO landscape architecture

MICHAEL D'ANGELO LANDSCAPE ARCHITECTURE LLC
732 EAST BROADWAY #3
BOSTON, MA 02127
1.203.592.4788
www.m-d-a.com

EMBLEM HYANNIS
35 SCUDDER AVENUE
HYANNIS, MA



REV. NO.	DATE	DESCRIPTION
1	4/11/21	CCC SUBMITTAL
2	10/21/22	CCC RESUBMITTAL

PLANTING AND LIGHTING PLAN

DRAWN
CHECKED
SCALE AS NOTED
DATE 03/01/21

L2

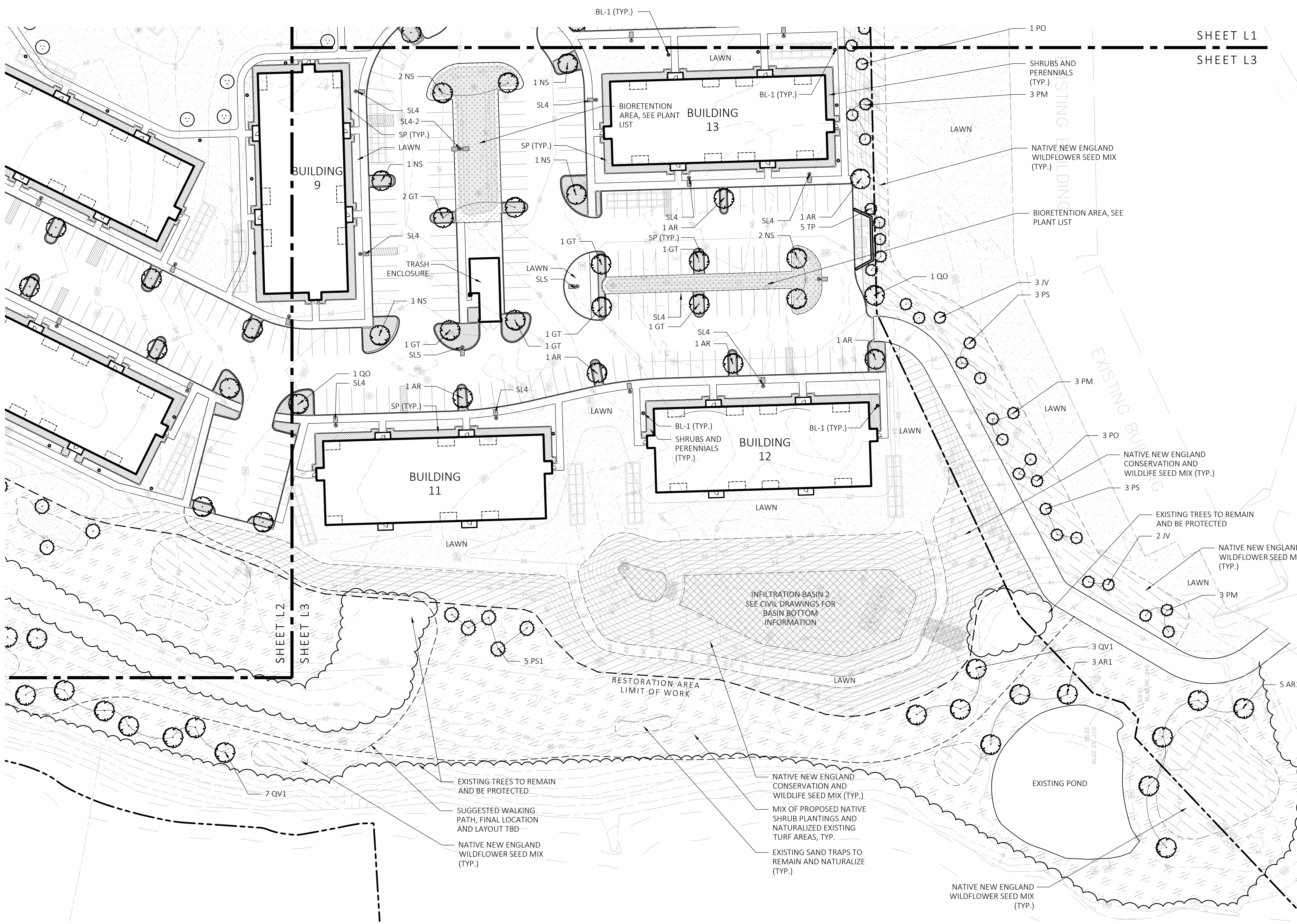

PLANT SCHEDULE - MAIN SITE					
SYMBOL	QTY.	LATIN NAME	COMMON NAME	SIZE	NOTES
SHADE TREES					
AR	72	ACER RUBRUM 'RED SUNSET'	RED SUNSET MAPLE	3"-3.5" CAL.	B&B, 6' CLEAR BRANCHING
GT	17	GLEDITSIA TRICANTHOS 'SKYLINE'	SKYLINE HONEYLOCUST	3"-3.5" CAL.	B&B, 6' CLEAR BRANCHING
NS	39	NYSSA SYLVATICA	BLACK TUPLO	3"-3.5" CAL.	B&B, 6' CLEAR BRANCHING
GB	3	QUERCUS BICOLOR	SWAMP WHITE OAK	3"-3.5" CAL.	B&B, 6' CLEAR BRANCHING
QC	4	QUERCUS COCCINEA	SCARLET OAK	3"-3.5" CAL.	B&B, 6' CLEAR BRANCHING
QO	12	QUERCUS PALUSTRIS	PIN OAK	3"-3.5" CAL.	B&B, 6' CLEAR BRANCHING
UA	2	LULIUS AMERICANA 'PRINCETON'	PRINCETON ELM	3"-3.5" CAL.	B&B, 6' CLEAR BRANCHING
ORNAMENTAL TREES					
AS	12	AMELANCHIER 'AUTUMN BRILLIANCE'	SERVICEBERRY	6-7' TALL	B&B, MULTI-STEM
BN	19	BETULA NIGRA 'HERITAGE'	RIVER BIRCH	10-12' TALL	B&B, MULTI-STEM
CC	3	CERCIS CANADENSIS	EASTERN REDBUD	6-7' TALL	B&B, SINGLE AND MULTI-STEM
MS	13	MAGNOLIA STELLATA	STAR MAGNOLIA	6-7' TALL	B&B, SPECIMEN
EVERGREEN TREES					
AC	10	ABIES CONCOLOR	WHITE FIR	7-8' TALL	B&B
JV	5	JUNIPERUS VIRGINIANA	EASTERN RED CEDAR	7-8' TALL	B&B
PM	17	PSEUDOTSUGA MENZIESII	DOUGLAS FIR	7-8' TALL	B&B
PD	4	PICEA GLAUCA	WHITE SPRUCE	7-8' TALL	B&B
PS	10	PINUS STROBUS	WHITE PINE	7-8' TALL	B&B
TP	8	THUJA PLICATA 'GREEN GIANT'	GREEN GIANT ARBORVITAE	7-8' TALL	B&B

SHRUBS PALETTE (SP)				
CA	CLETHRA ALNIFOLIA	SUMMERSWEET	3 GALLON	48" O.C. B&B
CS	CORNUS SERICEA 'ARCTIC FIRE'	ARCTIC FIRE DOGWOOD	3 GALLON	48" O.C. B&B
FG	FOTHERGILLA GARDENII	DWARF FOTHERGILLA	3 GALLON	48" O.C. B&B
HA	HYDRANGEA ARBORESCENS 'ANNABELLE'	ANNABELLE HYDRANGEA	3 GALLON	48" O.C. B&B
HP	HYDRANGEA PANICULATA 'LITTLE LIME'	LITTLE LIME HYDRANGEA	3 GALLON	48" O.C. B&B
HQ	HYDRANGEA QUERCIFOLIA	OAKLEAF HYDRANGEA	3 GALLON	48" O.C. B&B
IG	ILEX GLABRA	INKBERRY	3 GALLON	48" O.C. B&B
IV	ILEX VERTICILLATA	WINTERBERRY	3 GALLON	48" O.C. B&B
MP	MYRTICA PENNSYLVANICA	NORTHERN BAYBERRY	3 GALLON	48" O.C. B&B
RA	RHUS ARNICA 'GRO LOW'	GRO LOW SUMAC	3 GALLON	48" O.C. B&B
TM	TAXUS X MEDIA 'HICKSII'	HICKS YEW	3 GALLON	48" O.C. B&B
VA	VACCINIUM ANGUSTIFOLIUM	LOWBUSH BLUEBERRY	3 GALLON	48" O.C. B&B
VD	VIBURNUM DENTATUM	ARROWWOOD VIBURNUM	5 GALLON	48" O.C. B&B
PERENNIALS PALETTE (PP)				
AN	ASTER NOVIAE 'ANGUIAE'	NEW ENGLAND ASTER	1 GAL.	18" O.C. CONTAINER
DP	DENNSTAEDTIA PUNCTLOBULA	HAYSCENTED FERN	1 GAL.	18" O.C. CONTAINER
EP	ECHINACEA PURPUREA	PURPLE CONEFLOWER	1 GAL.	18" O.C. CONTAINER
HD	HEMEROCALLIS 'HAPPY RETURNS'	DAYLILY	1 GAL.	18" O.C. CONTAINER
LD	LEUCANTHEMUM X SUPERBUM 'BECKY'	BECKY DAISY	1 GAL.	18" O.C. CONTAINER
NF	NEPETA X FAASSENII 'WALKERS LOW'	CATMINT	1 GAL.	18" O.C. CONTAINER
PL	PEROVSKIA A. 'LITTLE SPIRE'	LITTLE SPIRE RUSSIAN SAGE	1 GAL.	18" O.C. CONTAINER
RF	RUBRICKIA FLUGIDA 'GOLDSTURM'	BLACK EYE SUSAN	1 GAL.	18" O.C. CONTAINER
TC	TIARELLA CORDIFOLIA	HEARTLEAF FOAMFLOWER	1 GAL.	18" O.C. CONTAINER
CM	CAREX MORROWII 'ICE DANCE'	JAPANESE SEDGE	1 GAL.	18" O.C. CONTAINER
CP	CAREX PENNSYLVANICA	PENNSYLVANIA SEDGE	1 GAL.	18" O.C. CONTAINER
LS	LIRIOPE SPICATA	LILY TURF	1 GAL.	18" O.C. CONTAINER
PV	PANICUM VIRGATUM 'SHENANDOAH'	SWITCH GRASS	2 GAL.	30" O.C. CONTAINER
SB	SCHIZACHYRIUM SCOPARIUM	LITTLE BLUESTEM	2 GAL.	30" O.C. CONTAINER
PA	PENNISETUM ALOPECUROIDES	FOUNTAIN GRASS	2 GAL.	24" O.C. CONTAINER

BIORETENTION AREA PALETTE				
SHRUBS				
CA	CLETHRA ALNIFOLIA	SWEET PEPPERBUSH	3 GAL.	48" O.C. CONTAINER
CS	CORNUS STOLONIFERA	REDTWIG DOGWOOD	3 GAL.	48" O.C. CONTAINER
IG	ILEX GLABRA	INKBERRY HOLLY	3 GAL.	48" O.C. CONTAINER
IV	ILEX VERTICILLATA	WINTERBERRY HOLLY	3 GAL.	48" O.C. CONTAINER
IT	ITEA VIRGINICA	VIRGINIA SWEETSPICE	3 GAL.	48" O.C. CONTAINER
VC	VACCINIUM CORBOSUM	HIGHBUSH BLUEBERRY	3 GAL.	48" O.C. CONTAINER
VD	VIBURNUM DENTATUM	ARROWWOOD VIBURNUM	3 GAL.	48" O.C. CONTAINER
PERENNIALS				
AT	ASCLEPIAS TUBEROSA	BUTTERFLY MILKWEED	1 GAL.	18" O.C. CONTAINER
BA	BAPTISIA AUSTRALIS	FALSE BLUE INDIGO	1 GAL.	18" O.C. CONTAINER
EP	ECHINACEA PURPUREA	PURPLE CONEFLOWER	1 GAL.	18" O.C. CONTAINER
EJ	EUPATORIUM PURPUREUM	JOE PYE WEED	1 GAL.	18" O.C. CONTAINER
BF	IRIS VERSICOLOR	BLUE FLAG IRIS	1 GAL.	18" O.C. CONTAINER
LB	LIATRIS LIGULISTYLIS	MEADOW BLAZING STAR	1 GAL.	18" O.C. CONTAINER
RH	RUBRICKIA HIRTA	BLACK EYED SUSAN	1 GAL.	18" O.C. CONTAINER
SS	PANICUM VIRGATUM 'SHENANDOAH'	SWITCHGRASS	1 GAL.	18" O.C. CONTAINER
SN	SYMPHYOTRICHUM NOVAE-ANGLIAE	NEW ENGLAND ASTER	1 GAL.	18" O.C. CONTAINER
TC	TIARELLA CORDIFOLIA	HEARTLEAF FOAMFLOWER	1 GAL.	18" O.C. CONTAINER

MEADOW SEED MIX				
NEW ENGLAND WETLAND PLANTS, INC.	"NEW ENGLAND CONSERVATION / WILDLIFE MIX"	25 LB/ACRE	APPLY COVER CROP; FALL: GRAIN RYE, SPRING: OAT; 800-873-3321; OR APPROVED EQUAL	
NEW ENGLAND WETLAND PLANTS, INC.	"NEW ENGLAND WILDFLOWER MIX"	23 LB/ACRE	APPLY COVER CROP; FALL: GRAIN RYE, SPRING: OAT; 800-873-3321; OR APPROVED EQUAL	
	INFILTRATION BASIN "BOTTOM"		SEE CIVIL DRAWINGS FOR BASIN BOTTOM INFORMATION	

PLANT SCHEDULE - RESTORATION AREA					
SYMBOL	QTY.	LATIN NAME	COMMON NAME	SIZE	NOTES
RESTORATION AREA - SHADE TREES					
AR1	16	ACER RUBRUM	RED MAPLE	1.5"-2" CAL.	B&B, 6' CLEAR BRANCHING
PC1	3	PRUNUS SEROTINA	BLACK CHERRY	1.5"-2" CAL.	B&B, 6' CLEAR BRANCHING
QV1	86	QUERCUS VELUTINA	BLACK OAK	1.5"-2" CAL.	B&B, 6' CLEAR BRANCHING
RESTORATION AREA - EVERGREEN TREES					
PR1	17	PINUS RIGIDA	PITCH PINE	7-8' TALL	B&B
PS1	22	PINUS STROBUS	WHITE PINE	7-8' TALL	B&B
RESTORATION AREA - SHRUBS					
MIX OF PROPOSED NATIVE SHRUBS PLANTINGS AND NATURALIZED EXISTING TURF AREAS. LOCATIONS AND QUANTITIES OF SHRUBS TBD					

LIGHT SCHEDULE						
SYMBOL	LABEL	MODEL	MOUNT	DESCRIPTION	OPTIONS	REP
☐	SL4	HUBBELL - RATIO SERIES RAR2-480L-185-4K7-4W-U	CONCRETE FOOTING; KEEP 24" ABOVE GRADE	SINGLE	COLOR: BLK	ILLUMINATE 617-947-8996 STEVE PRUDHOMME
☐	SL5	HUBBELL - RATIO SERIES RAR2-480L-185-4K7-5QW-U	CONCRETE FOOTING; KEEP 24" ABOVE GRADE	SINGLE	COLOR: BLK	
☐	SL4-2	HUBBELL - RATIO SERIES RAR2-480L-185-4K7-4W-U	CONCRETE FOOTING; KEEP 24" ABOVE GRADE	BACK-BACK	COLOR: BLK	
⊙	BL-1	ARLUCE - KLOU-K180 5-KK0204US-125-0870060D-740-12US	CONCRETE FOOTING; KEEP 3" ABOVE GRADE	SINGLE	COLOR: BLK	

RESTORATION AREA - SHADE TREES					
AR1	16	ACER RUBRUM	RED MAPLE	1.5"-2" CAL.	B&B, 6' CLEAR BRANCHING
PC1	3	PRUNUS SEROTINA	BLACK CHERRY	1.5"-2" CAL.	B&B, 6' CLEAR BRANCHING
QV1	86	QUERCUS VELUTINA	BLACK OAK	1.5"-2" CAL.	B&B, 6' CLEAR BRANCHING
RESTORATION AREA - EVERGREEN TREES					
PR1	17	PINUS RIGIDA	PITCH PINE	7-8' TALL	B&B
PS1	22	PINUS STROBUS	WHITE PINE	7-8' TALL	B&B
RESTORATION AREA - SHRUBS					
MIX OF PROPOSED NATIVE SHRUBS PLANTINGS AND NATURALIZED EXISTING TURF AREAS. LOCATIONS AND QUANTITIES OF SHRUBS TBD					

LIGHT SCHEDULE						
SYMBOL	LABEL	MODEL	MOUNT	DESCRIPTION	OPTIONS	REP
☐	SL4	HUBBELL - RATIO SERIES RAR2-480L-185-4K7-4W-U	CONCRETE FOOTING; KEEP 24" ABOVE GRADE	SINGLE	COLOR: BLK	ILLUMINATE 617-947-8996 STEVE PRUDHOMME
☐	SL5	HUBBELL - RATIO SERIES RAR2-480L-185-4K7-5QW-U	CONCRETE FOOTING; KEEP 24" ABOVE GRADE	SINGLE	COLOR: BLK	
☐	SL4-2	HUBBELL - RATIO SERIES RAR2-480L-185-4K7-4W-U	CONCRETE FOOTING; KEEP 24" ABOVE GRADE	BACK-BACK	COLOR: BLK	
⊙	BL-1	ARLUCE - KLOU-K180 5-KK0204US-125-0870060D-740-12US	CONCRETE FOOTING; KEEP 3" ABOVE GRADE	SINGLE	COLOR: BLK	

SUBMIT CUT SHEETS FOR APPROVAL; SEE PHOTOMETRIC PLAN PROVIDED WITH THIS DRAWING SET FOR MORE INFORMATION.

1 PLANTING & LIGHTING PLAN
SCALE: 1" = 40'-0"

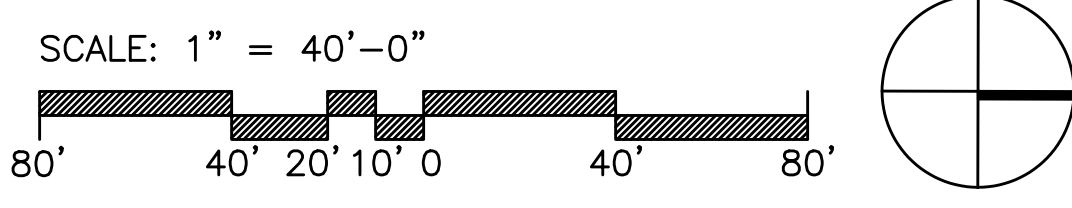

MDLA
MICHAEL D'ANGELO landscape architecture

MICHAEL D'ANGELO
LANDSCAPE ARCHITECTURE LLC
732 EAST BROADWAY #3
BOSTON, MA 02127
t. 203.592.4788
www.m-d-a.com

EMBLEM HYANNIS
35 SCUDDER AVENUE
HYANNIS, MA

STAMP
MASSACHUSETTS
LANDSCAPE ARCHITECT
MICHAEL D'ANGELO
NO. 4000
1000 STATE STREET
BOSTON, MA 02127

REV. NO.	DATE	DESCRIPTION
1	4/1/21	CC SUBMITTAL
2	10/21/22	CC RESUBMITTAL

PLANTING AND LIGHTING PLAN

CHECKED
SCALE
AS NOTED
DATE
03/01/21

L3

NOT FOR CONSTRUCTION

SHEET 4 OF 10
plot date: 11/2/2022

NOT FOR CONSTRUCTION

1 PLANTING & LIGHTING PLAN
SCALE: 1" = 40'-0"

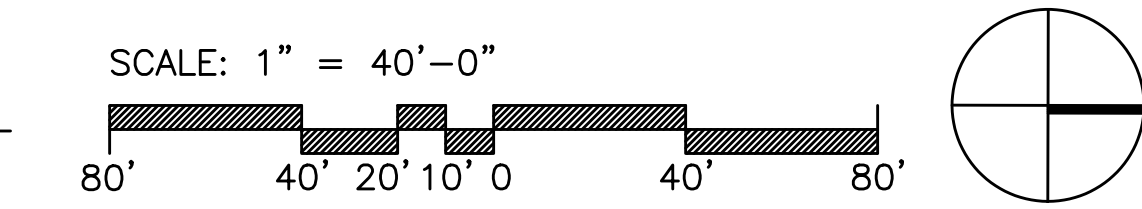
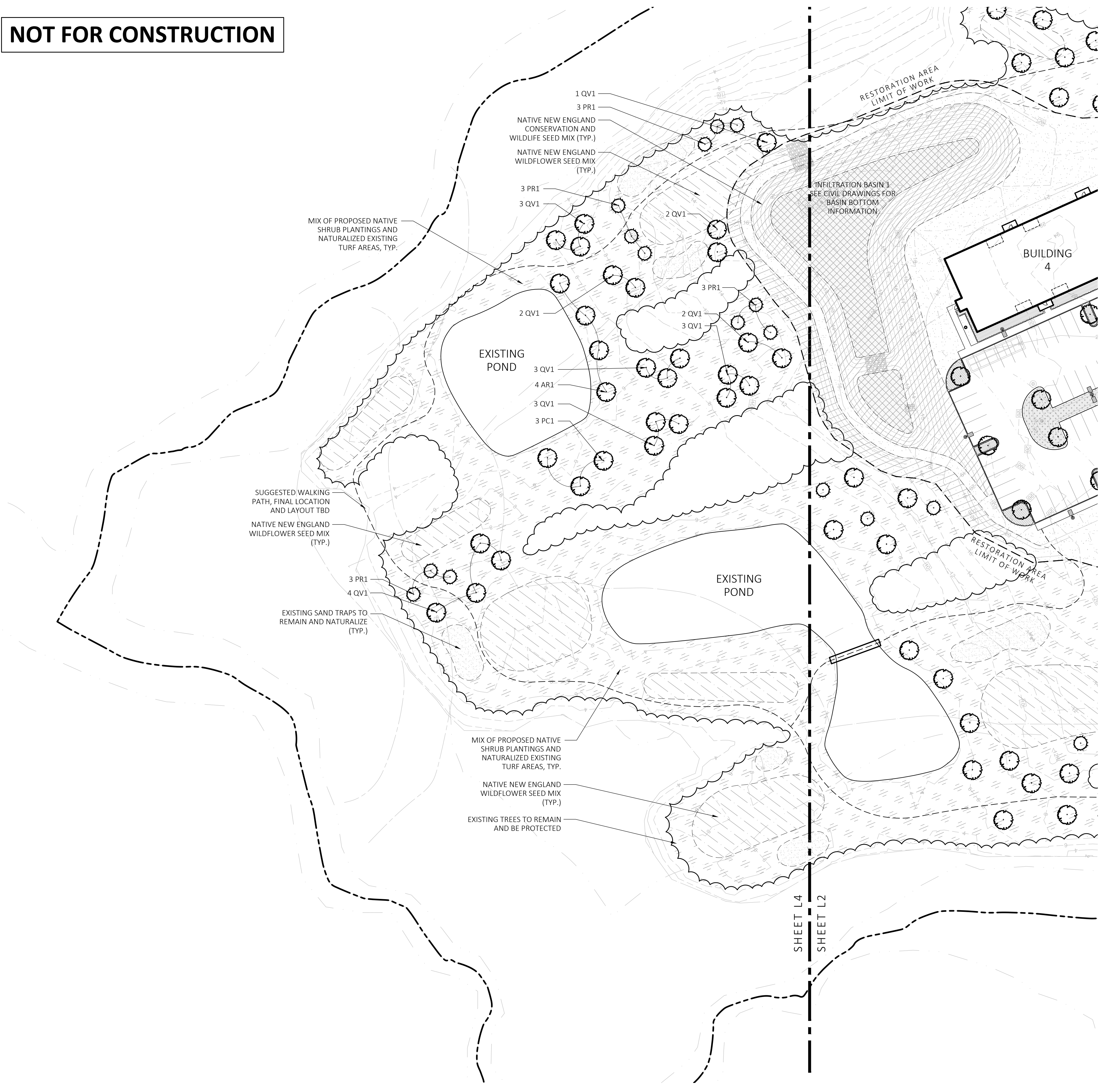

PLANT SCHEDULE - MAIN SITE					
SYMBOL	QTY.	LATIN NAME	COMMON NAME	SIZE	NOTES
SHADE TREES					
AR	72	ACER RUBRUM 'RED SUNSET'	RED SUNSET MAPLE	3"-3.5" CAL.	B&B, 6' CLEAR BRANCHING
GT	17	GLEDITSEA TRICANTHOS 'SKYLINE'	SKYLINE HONEYLOCUST	3"-3.5" CAL.	B&B, 6' CLEAR BRANCHING
NS	39	NYSSA SYLVATICA	BLACK TUPELO	3"-3.5" CAL.	B&B, 6' CLEAR BRANCHING
QB	3	QUERCUS BICOLOR	SWAMP WHITE OAK	3"-3.5" CAL.	B&B, 6' CLEAR BRANCHING
QC	4	QUERCUS COCCINEA	SCARLET OAK	3"-3.5" CAL.	B&B, 6' CLEAR BRANCHING
QO	12	QUERCUS PALUSTRIS	PIN OAK	3"-3.5" CAL.	B&B, 6' CLEAR BRANCHING
UA	2	ULMUS AMERICANA 'PRINCETON'	PRINCETON ELM	3"-3.5" CAL.	B&B, 6' CLEAR BRANCHING
ORNAMENTAL TREES					
AS	12	AMELANCHIER 'AUTUMN BRILLIANCE'	SERVICEBERRY	6-7' TALL	B&B, MULTI-STEM
BN	19	BETULA NIGRA 'HERITAGE'	RIVER BIRCH	10-12' TALL	B&B, MULTI-STEM
CC	3	CERCIS CANADENSIS	EASTERN REDBUD	6-7' TALL	B&B, SINGLE AND MULTI-STEM
MS	13	MAGNOLIA STELLATA	STAR MAGNOLIA	6-7' TALL	B&B, SPECIMEN
EVERGREEN TREES					
AC	10	ABIES CONCOLOR	WHITE FIR	7-8' TALL	B&B
JV	5	JUNIPERUS VIRGINIANA	EASTERN RED CEDAR	7-8' TALL	B&B
PM	17	PSEUDOTSUGA MENZIESII	DOUGLAS FIR	7-8' TALL	B&B
PO	4	PICEA GLAUCA	WHITE SPRUCE	7-8' TALL	B&B
PS	10	PINUS STROBUS	WHITE PINE	7-8' TALL	B&B
TP	8	THUJA PLICATA 'GREEN GIANT'	GREEN GIANT ARBORVITAE	7-8' TALL	B&B

SHRUBS PALETTE (SP)					
CA	CLETHRA ALNIFOLIA	SUMMERSWEET	3 GALLON	48" O.C. B&B	
CS	CORNUS SERICEA 'ARCTIC FIRE'	ARCTIC FIRE DOGWOOD	3 GALLON	48" O.C. B&B	
FG	FOTHERGILLA GARDENII	DWARF FOTHERGILLA	3 GALLON	48" O.C. B&B	
HA	HYDRANGEA ARBORESCENS 'ANNABELLE'	ANNABELLE HYDRANGEA	3 GALLON	48" O.C. B&B	
HP	HYDRANGEA PANICULATA 'LITTLE LIME'	LITTLE LIME HYDRANGEA	3 GALLON	48" O.C. B&B	
HQ	HYDRANGEA QUERCIFOLIA	OAKLEAF HYDRANGEA	3 GALLON	48" O.C. B&B	
IG	ILEX GLABRA	INKBERRY	3 GALLON	48" O.C. B&B	
IV	ILEX VERTICILLATA	WINTERBERRY	3 GALLON	48" O.C. B&B	
MP	MYRICA PENNSYLVANICA	NORTHERN BAYBERRY	3 GALLON	48" O.C. B&B	
RA	RHUS AROMATICA 'GRO LOW'	GRO LOW SUMAC	3 GALLON	48" O.C. B&B	
TM	TAXUS X MEDIA 'HICKSII'	HICKS YEW	3 GALLON	48" O.C. B&B	
VA	VACCINIUM ANGUSTIFOLIUM	LOWBUSH BLUEBERRY	3 GALLON	48" O.C. B&B	
VD	VIBURNUM DENTATUM	ARROWWOOD VIBURNUM	5 GALLON	48" O.C. B&B	
PERENNIALS PALETTE (PP)					
AN	ASTER NOVAE 'ANGLIAE'	NEW ENGLAND ASTER	1 GAL	18" O.C. CONTAINER	
DP	DENNSTAEDTIA PUNCTILOBULA	HAYCENTED FERN	1 GAL	18" O.C. CONTAINER	
EP	ECHINACEA PURPUREA	PURPLE CONEFLOWER	1 GAL	18" O.C. CONTAINER	
HD	HEMEROCALLIS 'HAPPY RETURNS'	DAYLILY	1 GAL	18" O.C. CONTAINER	
LD	LEUCANTHEMUM X SUPERBUM 'BECKY'	BECKY DAISY	1 GAL	18" O.C. CONTAINER	
NF	NEPETA X GASSNERI 'WALKERS LOW'	CATMINT	1 GAL	18" O.C. CONTAINER	
PL	PEROVSKIA 'LITTLE SPIRE'	LITTLE SPIRE RUSSIAN SAGE	1 GAL	18" O.C. CONTAINER	
RF	RUDBECKIA FULGIDA 'GOLDSTURM'	BLACK EYE SUSAN	1 GAL	18" O.C. CONTAINER	
TC	TIARELLA CORDIFOLIA	HEARTLEAF FOAMFLOWER	1 GAL	18" O.C. CONTAINER	
CM	CAREX MORROWII 'ICE DANCE'	JAPANESE SEDGE	1 GAL	18" O.C. CONTAINER	
CP	CAREX PENNSYLVANICA	PENNSYLVANIA SEDGE	1 GAL	18" O.C. CONTAINER	
LS	LIRIOPE SPICATA	LILY TURF	1 GAL	18" O.C. CONTAINER	
PV	PANICUM VIRGATUM 'SHENANDOAH'	SWITCH GRASS	2 GAL	30" O.C. CONTAINER	
SB	SCHIZACHYRIUM SCOPARIUM	LITTLE BLUESTEM	2 GAL	30" O.C. CONTAINER	
PA	PENNISETUM ALOPECUROIDES	FOUNTAIN GRASS	2 GAL	24" O.C. CONTAINER	

BIORETENTION AREA PALETTE					
SHRUBS					
CA	CLETHRA ALNIFOLIA	SWEET PEPPERBUSH	3 GAL	48" O.C. CONTAINER	
CS	CORNUS STOLONIFERA	REDTWIG DOGWOOD	3 GAL	48" O.C. CONTAINER	
IG	ILEX GLABRA	INKBERRY HOLLY	3 GAL	48" O.C. CONTAINER	
IV	ILEX VERTICILLATA	WINTERBERRY HOLLY	3 GAL	48" O.C. CONTAINER	
IT	ITEA VIRGINICA	VIRGINIA SWEETSPICE	3 GAL	48" O.C. CONTAINER	
VC	VACCINIUM CORYBOSUM	HIGHBUSH BLUEBERRY	3 GAL	48" O.C. CONTAINER	
VD	VIBURNUM DENTATUM	ARROWWOOD VIBURNUM	3 GAL	48" O.C. CONTAINER	
PERENNIALS					
AT	ASCLEPIAS TUBEROSA	BUTTERFLY MILKWEED	1 GAL	18" O.C. CONTAINER	
BA	BAPTISIA AUSTRALIS	FALSE BLUE INDIGO	1 GAL	18" O.C. CONTAINER	
EP	ECHINACEA PURPUREA	PURPLE CONEFLOWER	1 GAL	18" O.C. CONTAINER	
EJ	EUPATORIUM PURPUREUM	JOE PYE WEED	1 GAL	18" O.C. CONTAINER	
BF	IRIS VERSICOLOR	BLUE FLAG IRIS	1 GAL	18" O.C. CONTAINER	
LB	LIATRIS LIGULISTYLIS	MEADOW BLAZING STAR	1 GAL	18" O.C. CONTAINER	
RH	RUDBECKIA HIRTA	BLACK EYED SUSAN	1 GAL	18" O.C. CONTAINER	
PS	PANICUM VIRGATUM 'SHENANDOAH'	SWITCHGRASS	1 GAL	18" O.C. CONTAINER	
SS	SCHIZACHYRIUM SCOPARIUM	LITTLE BLUESTEM	1 GAL	18" O.C. CONTAINER	
SN	SYMPHYOTRICHUM NOVAE-ANGLIAE	NEW ENGLAND ASTER	1 GAL	18" O.C. CONTAINER	
TC	TIARELLA CORDIFOLIA	HEARTLEAF FOAMFLOWER	1 GAL	18" O.C. CONTAINER	

MEADOW SEED MIX					
NEW ENGLAND WETLAND PLANTS, INC.	"NEW ENGLAND CONSERVATION / WILDLIFE MIX"	25 LB/ACRE	APPLY COVER CROP; FALL: GRAIN RYE, SPRING: OAT; 800-873-3321; OR APPROVED EQUAL		
NEW ENGLAND WETLAND PLANTS, INC.	"NEW ENGLAND WILDFLOWER MIX"	23 LB/ACRE	APPLY COVER CROP; FALL: GRAIN RYE, SPRING: OAT; 800-873-3321; OR APPROVED EQUAL		
	INFILTRATION BASIN "BOTTOM"		SEE CIVIL DRAWINGS FOR BASIN BOTTOM INFORMATION		

PLANT SCHEDULE - RESTORATION AREA					
SYMBOL	QTY.	LATIN NAME	COMMON NAME	SIZE	NOTES
RESTORATION AREA - SHADE TREES					
AR1	16	ACER RUBRUM	RED MAPLE	1.5"-2" CAL.	B&B, 6' CLEAR BRANCHING
PC1	3	PRUNUS SEROTINA	BLACK CHERRY	1.5"-2" CAL.	B&B, 6' CLEAR BRANCHING
QV1	86	QUERCUS VELUTINA	BLACK OAK	1.5"-2" CAL.	B&B, 6' CLEAR BRANCHING
RESTORATION AREA - EVERGREEN TREES					
PR1	17	PINUS RIGIDA	PITCH PINE	7-8' TALL	B&B
PS1	22	PINUS STROBUS	WHITE PINE	7-8' TALL	B&B
RESTORATION AREA - SHRUBS					
MIX OF PROPOSED NATIVE SHRUBS PLANTINGS AND NATURALIZED EXISTING TURF AREAS. LOCATIONS AND QUANTITIES OF SHRUBS TBD					

LIGHT SCHEDULE						
SYMBOL	LABEL	MODEL	MOUNT	DESCRIPTION	OPTIONS	REP
☐	SL4	HUBBELL - RATIO SERIES RAR2-480L-185-4K7-4W-U	CONCRETE FOOTING; KEEP 24" ABOVE GRADE	SINGLE	COLOR: BLK	ILLUMINATE 617-947-8996 STEVE PRUDHOMME
☐	SL5	HUBBELL - RATIO SERIES RAR2-480L-185-4K7-SQW-U	CONCRETE FOOTING; KEEP 24" ABOVE GRADE	SINGLE	COLOR: BLK	
☐	SL4-2	HUBBELL - RATIO SERIES RAR2-480L-185-4K7-4W-U	CONCRETE FOOTING; KEEP 24" ABOVE GRADE	BACK-BACK	COLOR: BLK	
☉	BL-1	ARLUCE - KLOU-IK180 S-KK0204US-125-0870006D-740-12US	CONCRETE FOOTING; KEEP 3" ABOVE GRADE	SINGLE	COLOR: BLK	

SUBMIT CUT SHEETS FOR APPROVAL; SEE PHOTOMETRIC PLAN PROVIDED WITH THIS DRAWING SET FOR MORE INFORMATION.

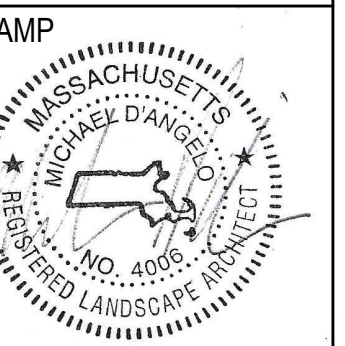

REV. NO.	DATE	DESCRIPTION
1	4/11/21	CC SUBMITTAL
2	10/21/22	CC RESUBMITTAL

PLANTING AND LIGHTING PLAN

DRAWN
CHECKED
SCALE AS NOTED
DATE 03/01/21
L4

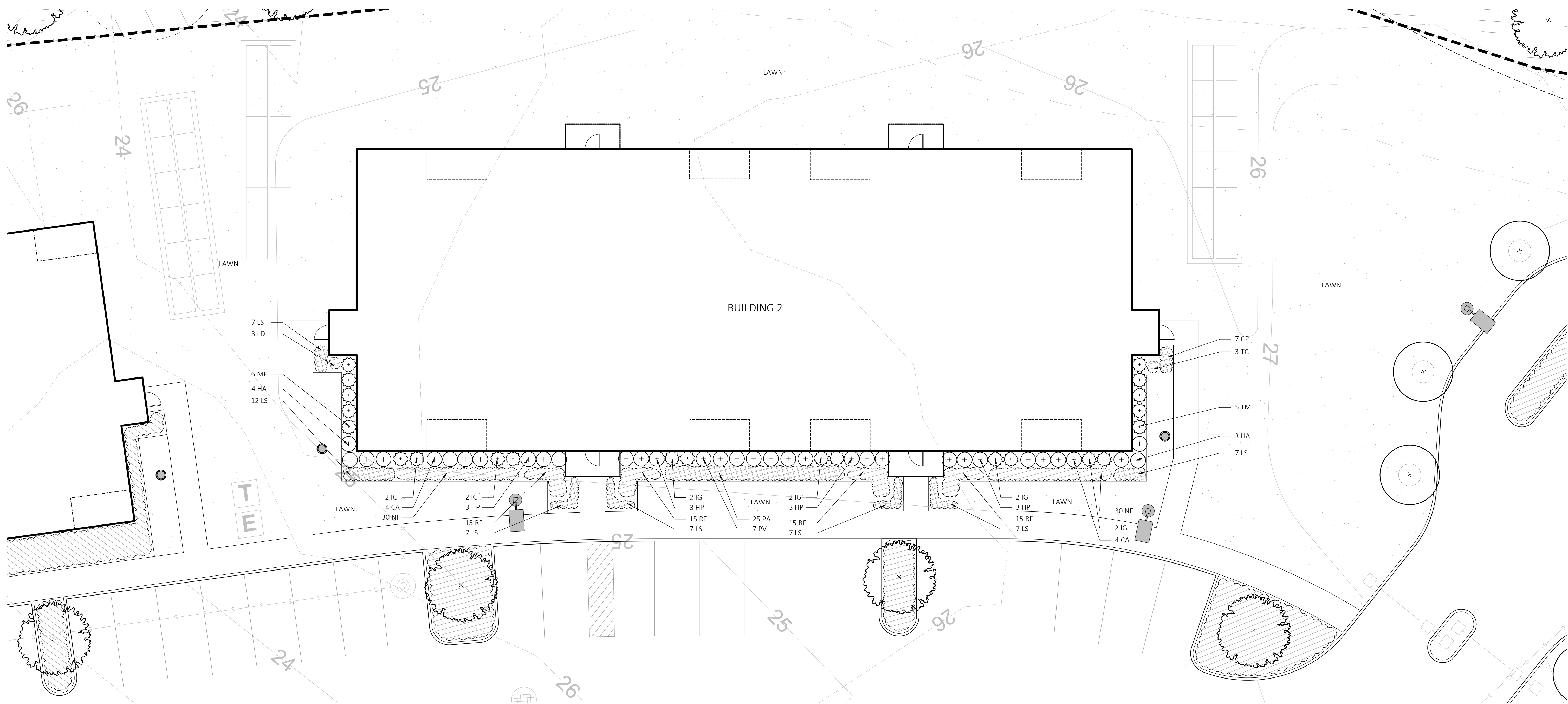

1 TYPICAL BUILDING PLANTING PLAN ENLARGEMENT
SCALE: 1" = 10'-0"

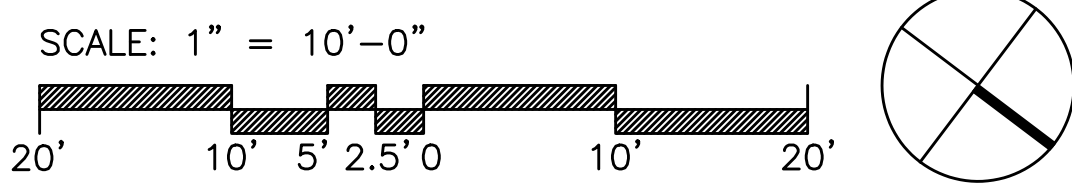

PLANT SCHEDULE - MAIN SITE					
SYMBOL	QTY.	LATIN NAME	COMMON NAME	SIZE	NOTES
SHADE TREES					
AR	72	ACER RUBRUM 'RED SUNSET'	RED SUNSET MAPLE	3"-3.5" CAL.	B&B, 6' CLEAR BRANCHING
GT	17	GLEDITSEA TRICANTHOS 'SKYLINE'	SKYLINE HONEYLOCUST	3"-3.5" CAL.	B&B, 6' CLEAR BRANCHING
NS	39	NYSSA SYLVATICA	BLACK TUPELO	3"-3.5" CAL.	B&B, 6' CLEAR BRANCHING
QB	3	QUERCUS BICOLOR	SWAMP WHITE OAK	3"-3.5" CAL.	B&B, 6' CLEAR BRANCHING
QC	4	QUERCUS COCCINEA	SCARLET OAK	3"-3.5" CAL.	B&B, 6' CLEAR BRANCHING
QO	12	QUERCUS PALUSTRIS	PIN OAK	3"-3.5" CAL.	B&B, 6' CLEAR BRANCHING
UA	2	ULMUS AMERICANA 'PRINCETON'	PRINCETON ELM	3"-3.5" CAL.	B&B, 6' CLEAR BRANCHING
ORNAMENTAL TREES					
AS	12	AMELANCHIER 'AUTUMN BRILLIANCE'	SERVICEBERRY	6-7' TALL	B&B, MULTI-STEM
BN	19	BETULA NIGRA 'HERITAGE'	RIVER BIRCH	10-12' TALL	B&B, MULTI-STEM
CC	3	CERCIS CANADENSIS	EASTERN REDBUD	6-7' TALL	B&B, SINGLE AND MULTI-STEM
MS	13	MAGNOLIA STELLATA	STAR MAGNOLIA	6-7' TALL	B&B, SPECIMEN
EVERGREEN TREES					
AC	10	ABIES CONCOLOR	WHITE FIR	7-8' TALL	B&B
JV	5	JUNIPERUS VIRGINIANA	EASTER RED CEDAR	7-8' TALL	B&B
PM	17	PSEUDOTSUGA MENZIESII	DOUGLAS FIR	7-8' TALL	B&B
PO	4	PICEA GLAUCA	WHITE SPRUCE	7-8' TALL	B&B
PS	10	PINUS STROBUS	WHITE PINE	7-8' TALL	B&B
TP	8	THUJA PLICATA 'GREEN GIANT'	GREEN GIANT ARBORVITAE	7-8' TALL	B&B

SHRUBS PALETTE (SP)					
CA	CLETHERA ALNIFOLIA	SUMMERSWEET	3 GALLON	48" O.C. B&B	
CS	CORNUS SERICEA 'ARCTIC FIRE'	ARCTIC FIRE DOGWOOD	3 GALLON	48" O.C. B&B	
FG	FOTHERGILLA GARDENII	DWARF FOTHERGILLA	3 GALLON	48" O.C. B&B	
HA	HYDRANGEA ARBORESCENS 'ANNABELLE'	ANNABELLE HYDRANGEA	3 GALLON	48" O.C. B&B	
HP	HYDRANGEA PANICULATA 'LITTLE LIME'	LITTLE LIME HYDRANGEA	3 GALLON	48" O.C. B&B	
HQ	HYDRANGEA QUERCIFOLIA	OAKLEAF HYDRANGEA	3 GALLON	48" O.C. B&B	
IG	ILEX GLABRA	INKBERRY	3 GALLON	48" O.C. B&B	
IV	ILEX VERTICILLATA	WINTERBERRY	3 GALLON	48" O.C. B&B	
MP	MYRICA PENNSYLVANICA	NORTHERN BAYBERRY	3 GALLON	48" O.C. B&B	
RA	RHUS AROMATICA 'GRO LOW'	GRO LOW SUMAC	3 GALLON	48" O.C. B&B	
TM	TAXUS X MEDIA 'HICKSII'	HICKS YEW	3 GALLON	48" O.C. B&B	
VA	VACCINIUM ANGUSTIFOLIUM	LOWBUSH BLUEBERRY	3 GALLON	48" O.C. B&B	
VD	VIBURNUM DENTATUM	ARROWWOOD VIBURNUM	5 GALLON	48" O.C. B&B	
PERENNIALS PALETTE (PP)					
AN	ASTER NOVAE 'ANGLIAE'	NEW ENGLAND ASTER	1 GAL	18" O.C. CONTAINER	
DP	DENNSTAEDTIA PUNCTILOBULA	HAYCENTED FERN	1 GAL	18" O.C. CONTAINER	
EP	ECHINACEA PURPUREA	PURPLE CONEFLOWER	1 GAL	18" O.C. CONTAINER	
FD	HEMEROCALLIS 'HAPPY RETURNS'	DAKILILY	1 GAL	18" O.C. CONTAINER	
LD	LEUCANTHEMUM X SUPERBUM 'BECKY'	BECKY DAISY	1 GAL	18" O.C. CONTAINER	
NF	NEPETA X FAASSENII 'WALKERS LOW'	CATMINT	1 GAL	18" O.C. CONTAINER	
PL	PEROVSKIA A. 'LITTLE SPIRE'	LITTLE SPIRE RUSSIAN SAGE	1 GAL	18" O.C. CONTAINER	
RF	RUDBECKIA FULGIDA 'GOLDSTURM'	BLACK EYE SUSAN	1 GAL	18" O.C. CONTAINER	
TC	TIARELLA CORDIFOLIA	HEARTLEAF FOAMFLOWER	1 GAL	18" O.C. CONTAINER	
CM	CAREX MORROWII 'ICE DANCE'	JAPANESE SEDGE	1 GAL	18" O.C. CONTAINER	
CP	CAREX PENNSYLVANICA	PENNSYLVANIA SEDGE	1 GAL	18" O.C. CONTAINER	
LS	LIRIOPE SPICATA	LILY TURF	1 GAL	18" O.C. CONTAINER	
PV	PANICUM VIRGATUM 'SHENANDOAH'	SWITCH GRASS	2 GAL	30" O.C. CONTAINER	
SB	SCHIZACHYRIUM SCOPARIUM	LITTLE BLUESTEM	2 GAL	30" O.C. CONTAINER	
PA	PENNISETUM ALOPECUROIDES	FOUNTAIN GRASS	2 GAL	24" O.C. CONTAINER	

- PLANTING:
- DURING CONSTRUCTION, PROTECT ALL EXISTING SITE FEATURES, STRUCTURES AND UTILITIES.
 - PLANTS SHALL BE TRUE TO SPECIES AND VARIETY SPECIFIED AND NURSERY GROWN IN ACCORDANCE WITH THE AMERICAN STANDARD FOR NURSERY STOCK UNDER CLIMATIC CONDITIONS SIMILAR TO THOSE IN THE LOCALITY OF THE PROJECT. SUBSTITUTIONS WILL BE PERMITTED ONLY IF APPROVED BY THE LANDSCAPE ARCHITECT.
 - LANDSCAPE ARCHITECT APPROVAL IS REQUIRED BEFORE PLANT MATERIAL IS PURCHASED. LANDSCAPE ARCHITECT RESERVES THE RIGHT TO SEE ALL MATERIAL IN PERSON AT THE NURSERY. IF TRAVEL OUTSIDE OF MA IS REQUIRED, LANDSCAPE ARCHITECT'S TRAVEL COSTS SHALL BE PAID FOR BY THE CONTRACTOR.
 - ALL EXPOSED BURLAP, WIRE BASKETS AND OTHER MATERIALS ATTACHED TO PLANTS SHALL BE REMOVED PRIOR TO PLANTING. CARE SHALL BE TAKEN NOT TO DISTURB THE ROOT BALL OF PLANTS.
 - THOROUGHLY WATER ALL PLANTS IMMEDIATELY AFTER PLANTING.
 - WHERE DISCREPANCIES IN QUANTITIES OCCUR, DRAWINGS SUPERCEDE PLANT NOTES AND SCHEDULE.
 - TRANSPLANTING SHALL BE DONE IN ACCORDANCE WITH THE AMERICAN STANDARD FOR NURSERY STOCK.
 - LOAM USED IN PLANT BEDS SHALL BE UNIFORM IN COMPOSITION, FREE FROM SUBSOIL, STONES LARGER THAN 1", NOXIOUS SEEDS AND SUITABLE FOR THE SUPPORT OF VEGETATIVE GROWTH. THE pH VALUE SHALL BE BETWEEN 5.5 AND 6.5.
 - MULCH IN TREE AND SHRUB BEDS SHALL BE NATURAL, NATIVE HEMLOCK MULCH FREE OF GROWTH OR GERMINATION INHIBITING INGREDIENTS. SUBMIT SAMPLES FOR APPROVAL.
 - LOCATIONS FOR PLANTS AND/OR OUTLINE OF AREAS TO BE PLANTED ARE TO BE STAKED OUT AT THE SITE FOR APPROVAL BY THE LANDSCAPE ARCHITECT.
 - SOIL DEPTHS: a.) SHRUBS AND PERENNIAL BEDS: 18" MIN.; b.) GROUND COVER: 6" MIN.; c.) TREES: PER CONSTRUCTION DETAIL; d.) SOD/SEED: 6" MIN.
 - PROVIDE A SUBSURFACE ROOTBALL ANCHOR BY PLATIPUS EARTH ANCHORS, OR APPROVED EQUAL. SIZE FOR CALIPER AND HEIGHT.

NOT FOR CONSTRUCTION

MDLA
MICHAEL D'ANGELO landscape architecture

MICHAEL D'ANGELO
LANDSCAPE ARCHITECTURE LLC

732 EAST BROADWAY #3
BOSTON, MA 02127
t. 203.592.4788
www.m-d-l-a.com

EMBLEM HYANNIS
35 SCUDDER AVENUE
HYANNIS, MA

STAMP
MASSACHUSETTS
MICHAEL D'ANGELO
LANDSCAPE ARCHITECT
NO. 4068

REV. NO.	DATE	DESCRIPTION
1	4/11/21	CCC SUBMITTAL
2	10/21/22	CCC RESUBMITTAL

TYPICAL BUILDING PLANTING PLAN ENLARGEMENT

DRAWN
CHECKED
SCALE AS NOTED
DATE 03/01/21

L5

SHEET 6 OF 10

plot date: 11/2/2022

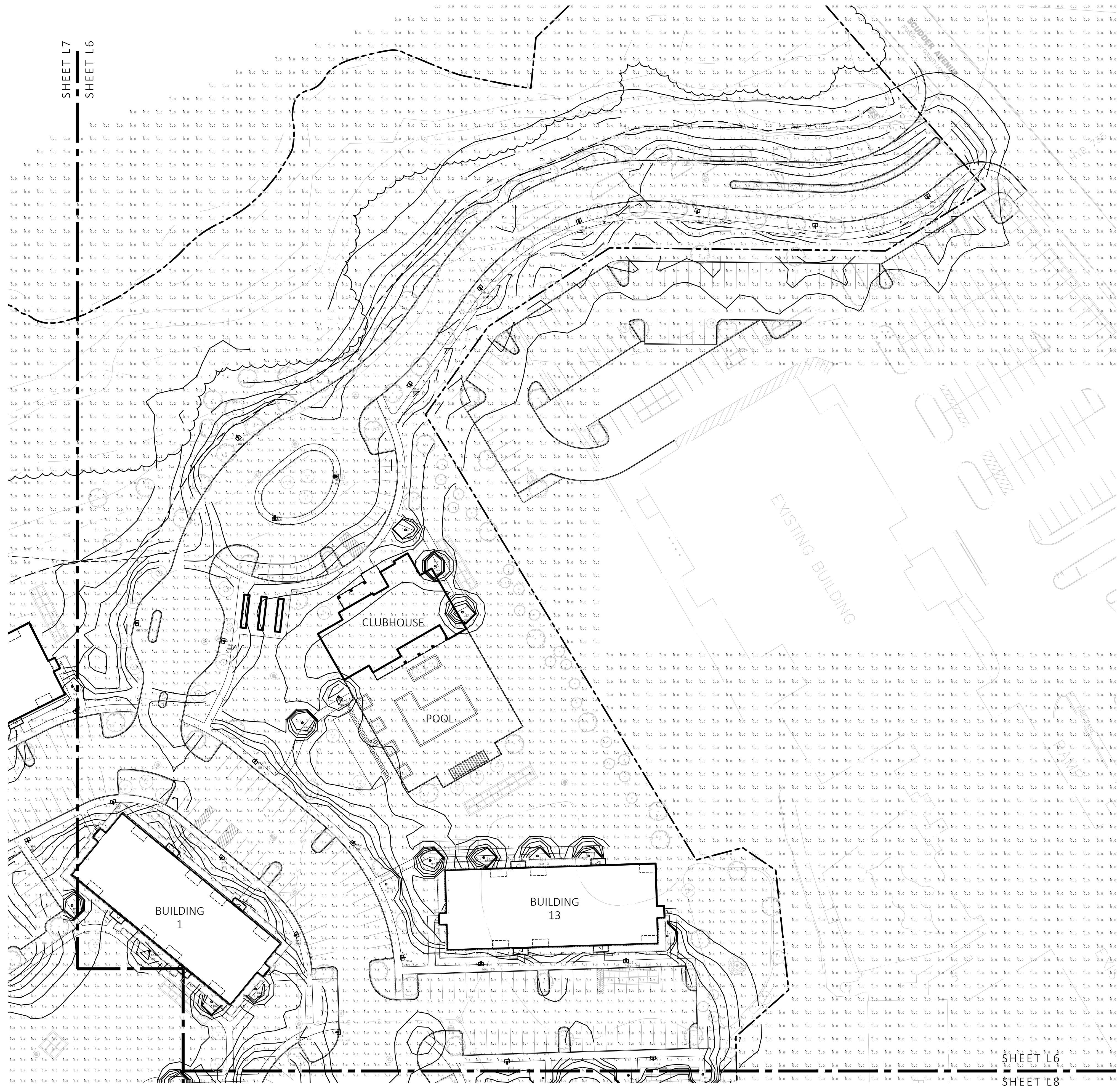

1 PHOTOMETRIC PLAN
SCALE: 1" = 40'-0"

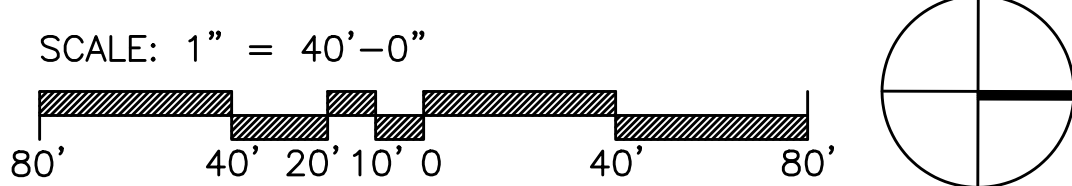

Symbol	Qty	Label	Arrangement	LLF	Description	Lum. Lumens
[Symbol]	52	SL4	SINGLE	0.900	RAR2-480L-185-4K7-4W-U	25636
[Symbol]	5	SL5	SINGLE	0.900	RAR2-480L-185-4K7-5QW-U	26266
[Symbol]	2	SL4-2	BACK-BACK	0.900	RAR2-480L-185-4K7-4W-U	25636
[Symbol]	51	BL-1	SINGLE	1.000	5-KK0204US-125-0870006D-740-12US	1356

Label	CalcType	Units	Avg	Max	Min	Avg/Min	Max/Min
LANDSCAPE AREAS	Illuminance	Fc	0.82	19.2	0.0	N.A.	N.A.
PARKING + ROADWAYS	Illuminance	Fc	4.26	10.7	0.4	10.65	26.75
SPILL LIGHT	Illuminance	Fc	0.01	3.3	0.0	N.A.	N.A.

NOT FOR CONSTRUCTION

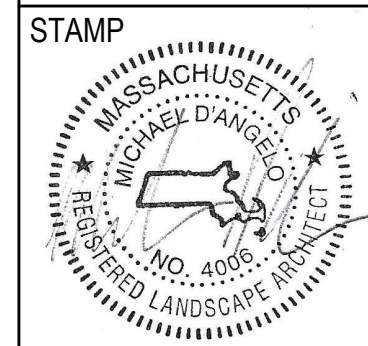

REV. NO.	DATE	DESCRIPTION
1	4/11/21	CCC SUBMITTAL
2	10/21/22	CCC RESUBMITTAL

PHOTOMETRIC PLAN

DRAWN: [Blank]
CHECKED: [Blank]
SCALE: AS NOTED
DATE: 03/01/21
L6

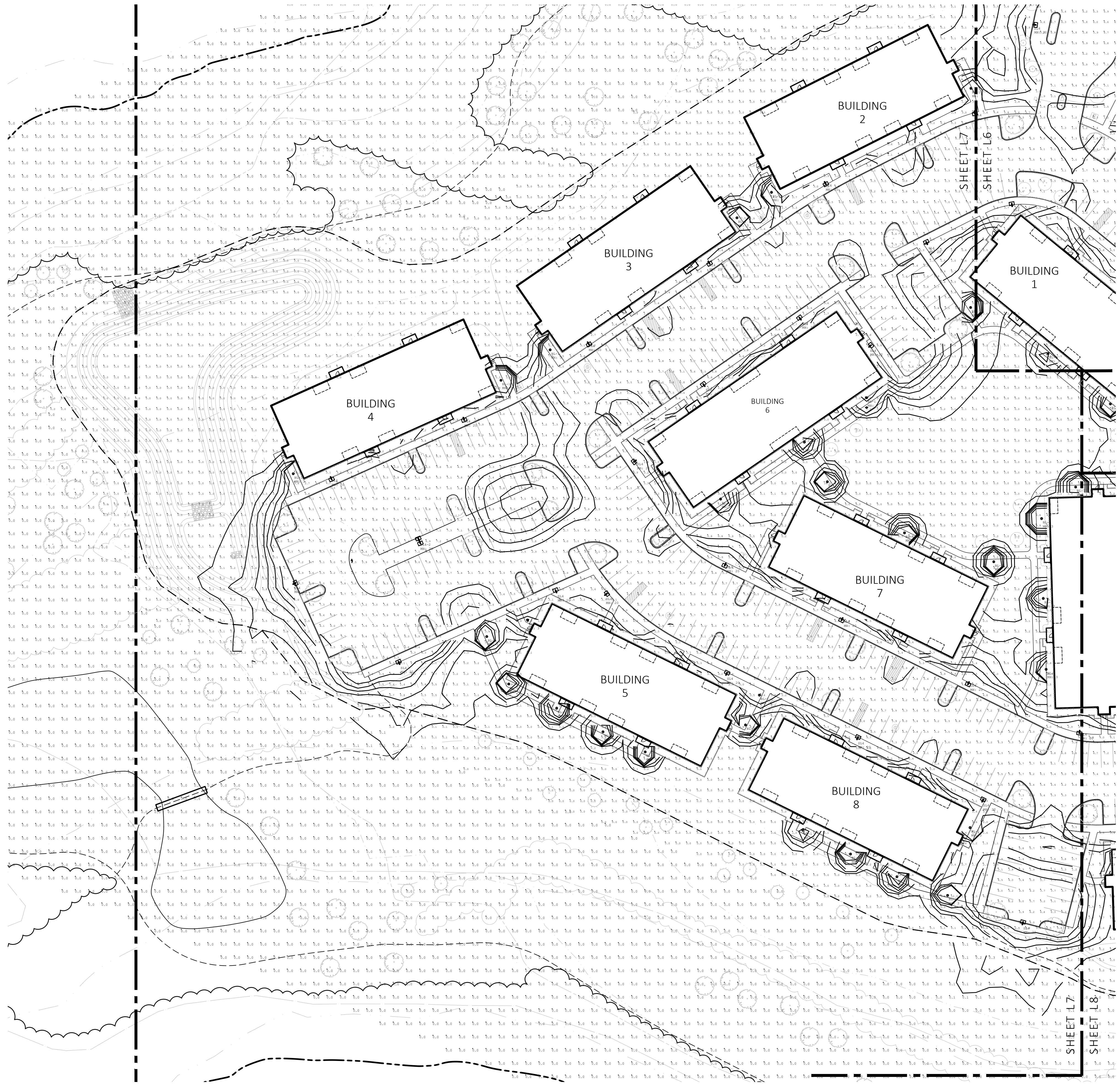

1 PHOTOMETRIC PLAN
SCALE: 1" = 40'-0"

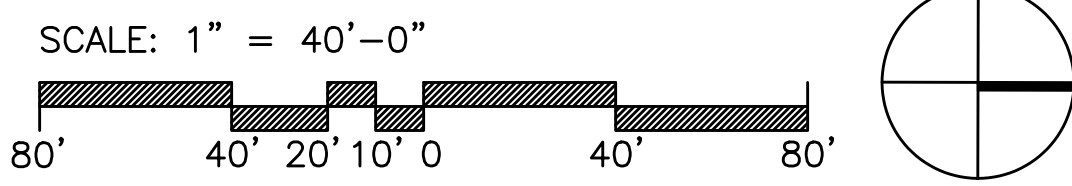

Symbol	Qty	Label	Arrangement	LLF	Description	Lum. Lumens
[Symbol]	52	SL4	SINGLE	0.900	RAR2-480L-185-4K7-4W-U	25636
[Symbol]	5	SL5	SINGLE	0.900	RAR2-480L-185-4K7-5QW-U	26266
[Symbol]	2	SL4-2	BACK-BACK	0.900	RAR2-480L-185-4K7-4W-U	25636
[Symbol]	51	BL-1	SINGLE	1.000	5-KK0204US-125-0870006D-740-12US	1356

Label	CalcType	Units	Avg	Max	Min	Avg/Min	Max/Min
LANDSCAPE AREAS	Illuminance	Fc	0.82	19.2	0.0	N.A.	N.A.
PARKING + ROADWAYS	Illuminance	Fc	4.26	10.7	0.4	10.65	26.75
SPILL LIGHT	Illuminance	Fc	0.01	3.3	0.0	N.A.	N.A.

NOT FOR CONSTRUCTION

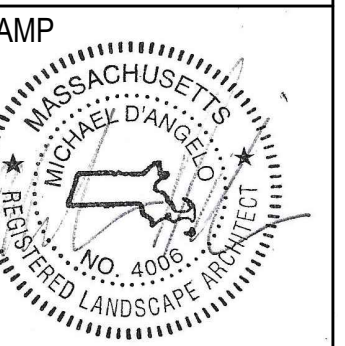

REV. NO.	DATE	DESCRIPTION
1	4/11/21	CCC SUBMITTAL
2	10/21/22	CCC RESUBMITTAL

PHOTOMETRIC PLAN

DRAWN: [Blank]
CHECKED: [Blank]
SCALE: AS NOTED
DATE: 03/01/21
L7

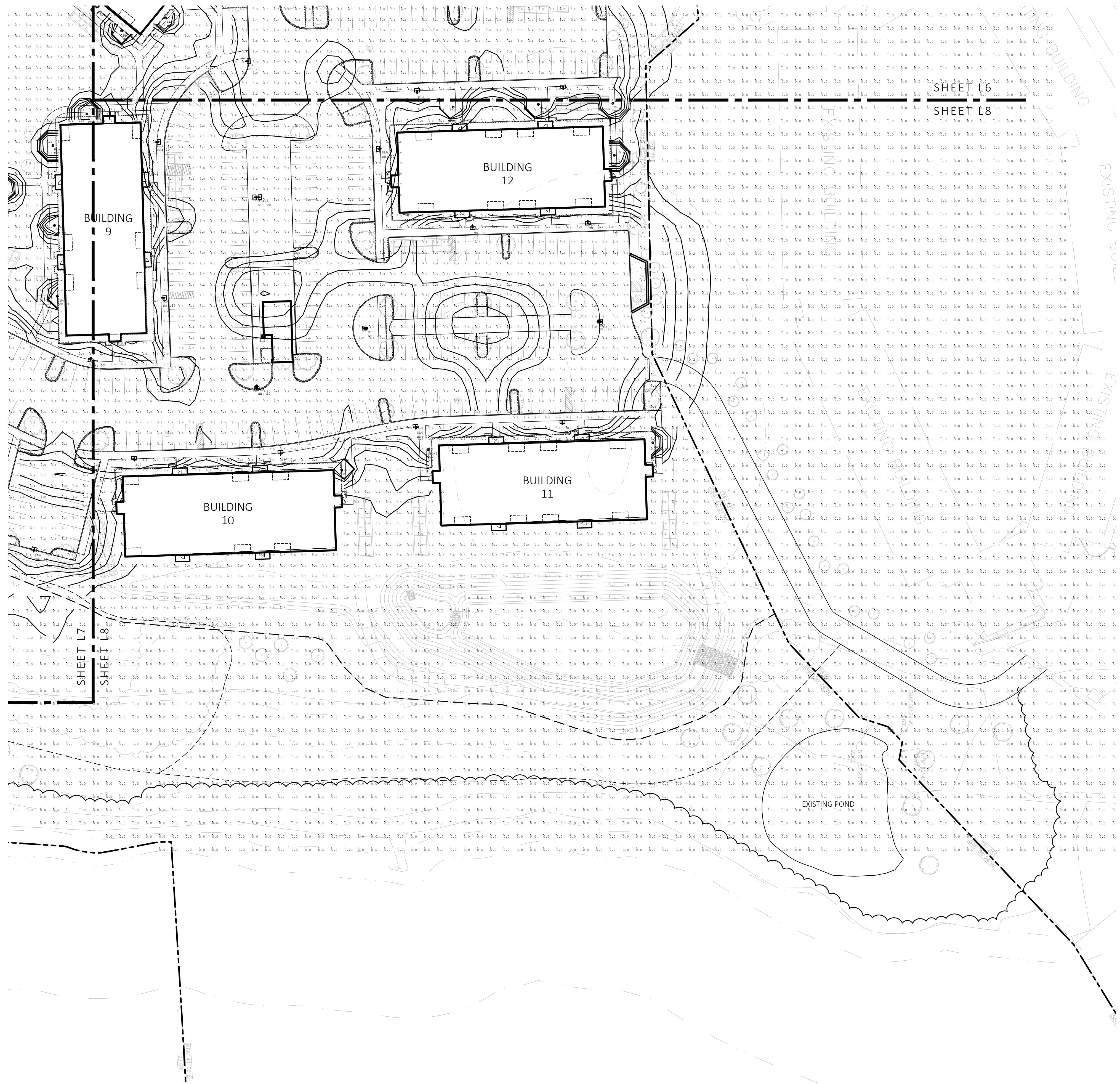

1 PHOTOMETRIC PLAN
SCALE: 1" = 40'-0"

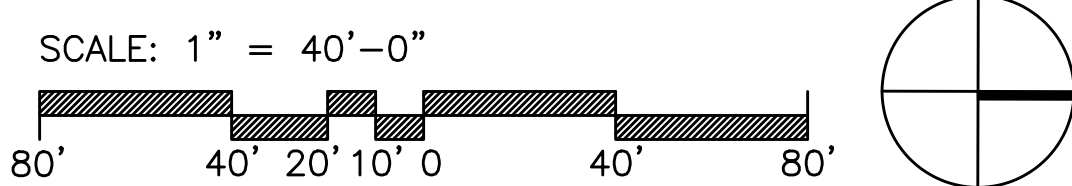

Symbol	Qty	Label	Arrangement	LLF	Description	Lum. Lumens
[Symbol]	52	SL4	SINGLE	0.900	RAR2-480L-185-4K7-4W-U	25636
[Symbol]	5	SL5	SINGLE	0.900	RAR2-480L-185-4K7-5QW-U	26266
[Symbol]	2	SL4-2	BACK-BACK	0.900	RAR2-480L-185-4K7-4W-U	25636
[Symbol]	51	BL-1	SINGLE	1.000	5-KK0204US-125-0870006D-740-12US	1356

Label	CalcType	Units	Avg	Max	Min	Avg/Min	Max/Min
LANDSCAPE AREAS	Illuminance	Fc	0.82	19.2	0.0	N.A.	N.A.
PARKING + ROADWAYS	Illuminance	Fc	4.26	10.7	0.4	10.65	26.75
SPILL LIGHT	Illuminance	Fc	0.01	3.3	0.0	N.A.	N.A.

NOT FOR CONSTRUCTION

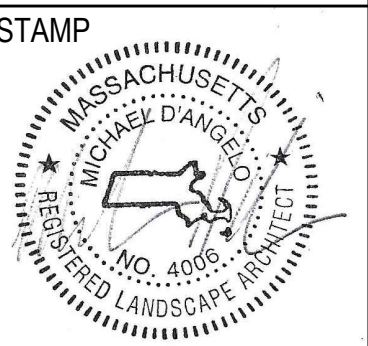

REV. NO.	DATE	DESCRIPTION
1	4/11/21	CCC SUBMITTAL
2	10/21/22	CCC RESUBMITTAL

PHOTOMETRIC PLAN

DRAWN	L8
CHECKED	
SCALE AS NOTED	
DATE 03/01/21	

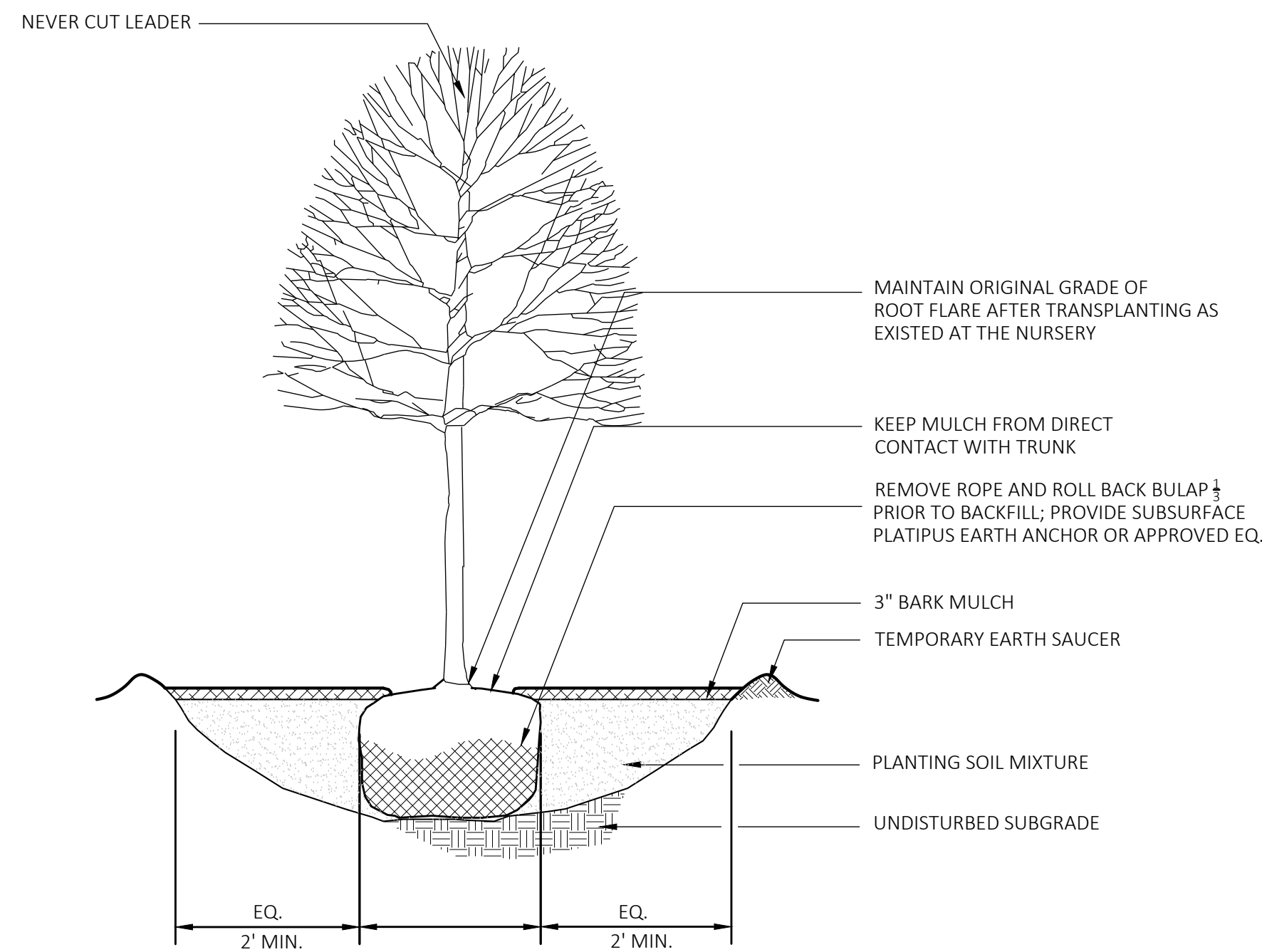

1 DECIDUOUS TREE PLANTING
SCALE: N.T.S.

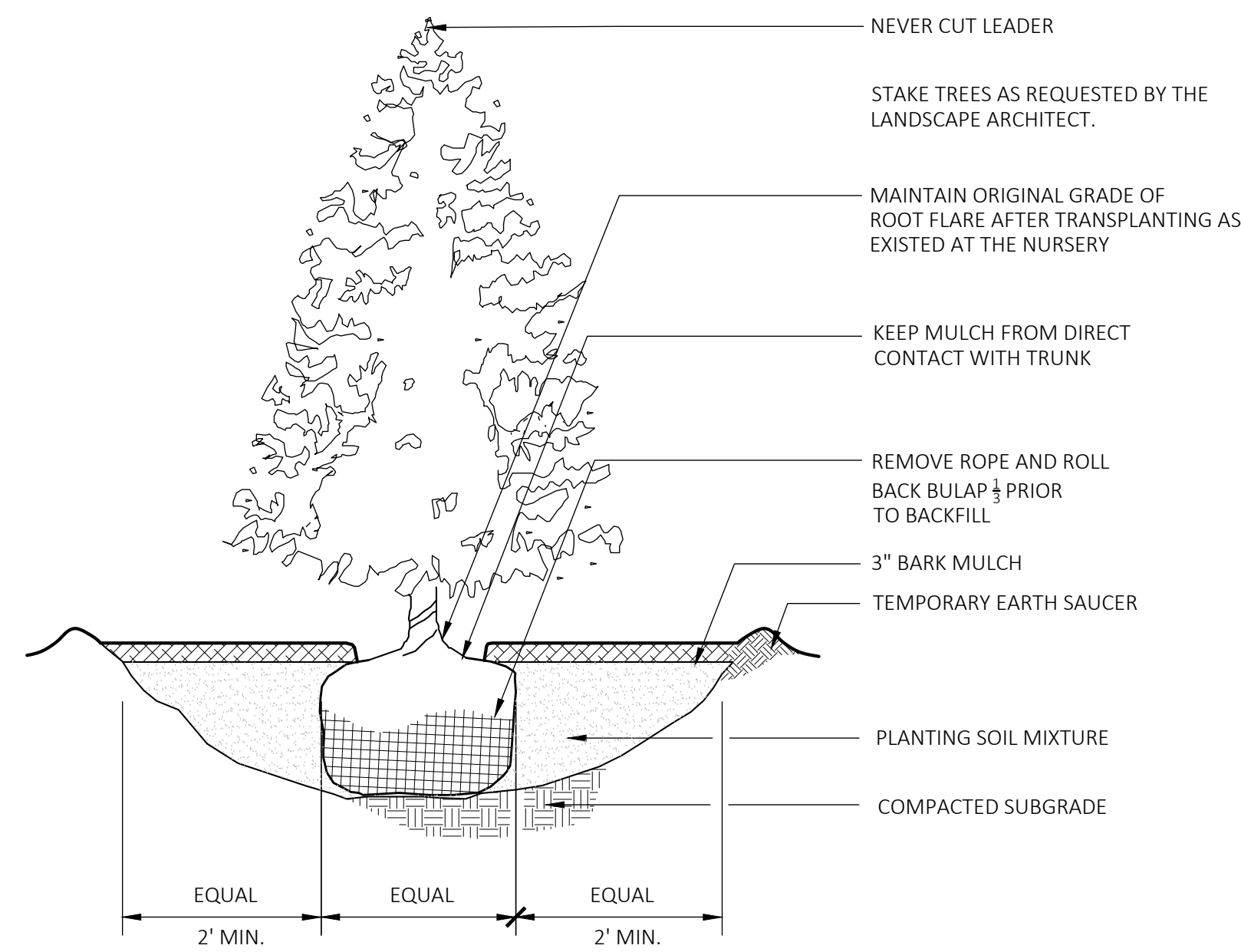

2 EVERGREEN TREE PLANTING
SCALE: N.T.S.

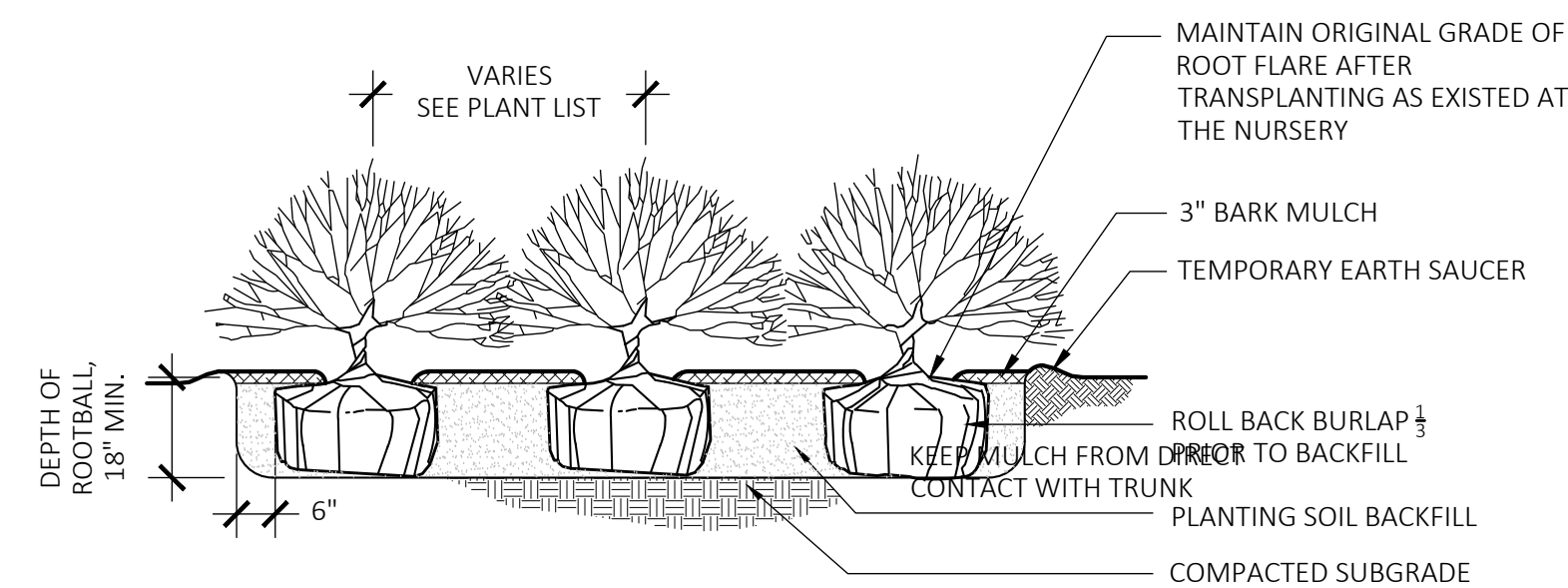

3 SHRUB PLANTING
SCALE: N.T.S.

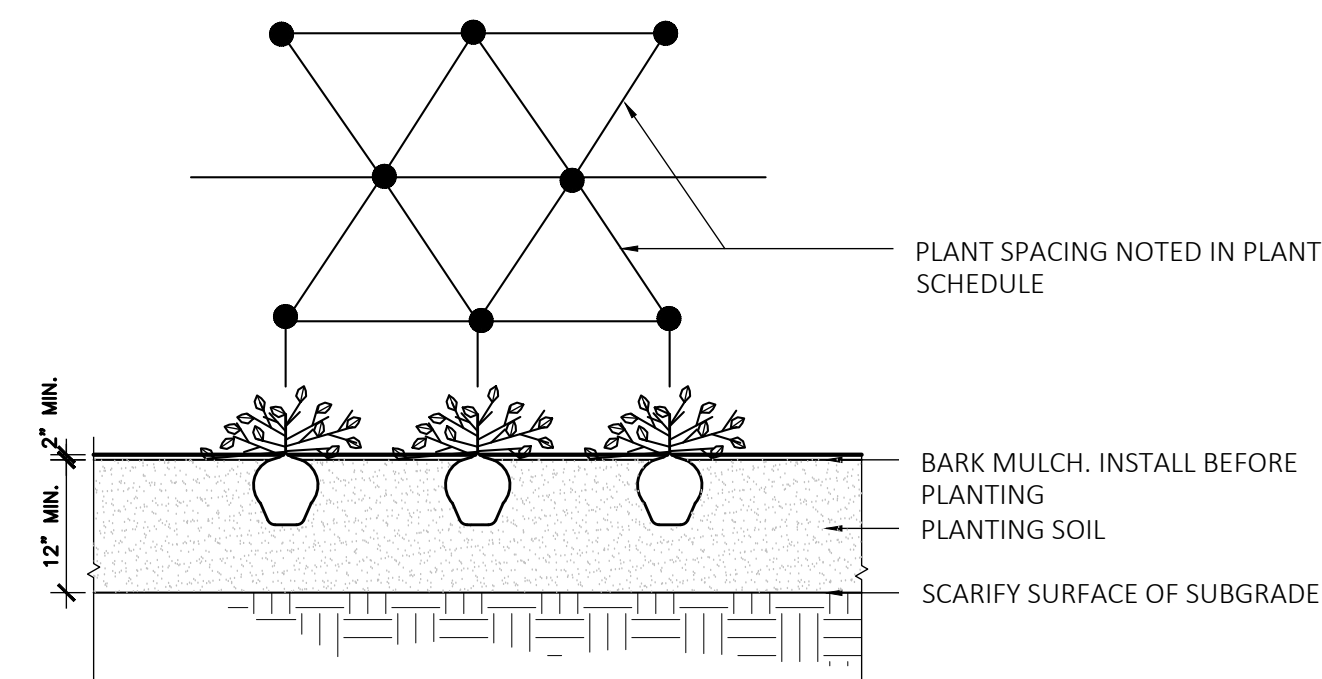

4 GROUNDCOVER PLANTING
SCALE: N.T.S.

RATIO Series
AREAS: SITE LIGHTING

FEATURES

- Low profile LED available in various sizes with a variety of LED distributions for lighting applications from low wall sconces and recessed lighting to high bay lighting.
- Available in multiple finishes and colors.
- Available in multiple sizes and configurations.
- Available in multiple voltages and wattages.
- Available in multiple mounting options.
- Available in multiple beam spreads.
- Available in multiple mounting heights.
- Available in multiple mounting orientations.
- Available in multiple mounting locations.
- Available in multiple mounting depths.
- Available in multiple mounting widths.
- Available in multiple mounting heights.
- Available in multiple mounting orientations.
- Available in multiple mounting locations.
- Available in multiple mounting depths.
- Available in multiple mounting widths.

CONTROL TECHNOLOGY

SiteLight™ NX DISTRIBUTED INTELLIGENCE wISCAPE™

KEY DATA

Light Range	1000-4000
Beam Range	25-100
Efficacy Range (lm/W)	75-100
Mounting Options	10000
Material Options	30-300

5 SL4, SL4-2 AND SL5 POLE LIGHT
SCALE: N.T.S.

Arcluce
KLOU-IK180 (Model)

TECHNICAL INFORMATION

Watt	50W - 250W
Luminaire	Up to 1450lm
CCT	3000K - 4000K
CR	>70 - >80
Wing	150V 60Hz, 120-277V 60Hz / 5-10V
LED life time	> 50000 hrs (L80, L70, L60, L50, L40, L30, L20, L10)
Color	Black / 12' / Aluminum - 21 / Grey - 10

DESCRIPTION

Construction

- Die-cast aluminum body (EN 47100).
- Engraved aluminum plate.
- Die-cast for protection powder paint resistant to corrosion.
- Self-cleaning surface.
- Available in multiple finishes and colors.
- Available in multiple sizes and configurations.
- Available in multiple voltages and wattages.
- Available in multiple mounting options.
- Available in multiple beam spreads.
- Available in multiple mounting heights.
- Available in multiple mounting orientations.
- Available in multiple mounting locations.
- Available in multiple mounting depths.
- Available in multiple mounting widths.

Electrical & Optics

- Universal input voltage: 120-277V 60Hz or 120V/240V/277V according to model variant.
- 5-10V dimming available.
- High efficacy LEDs with standard 3000K, 4000K (2700K or other CCTs available on request).
- Beam made of 5/8" thermal shock resistant tempered glass.

INSTALLATION

- Surface installation.
- Double cable gland M20 for through wiring.
- Die-cast aluminum base (EN 47100) for anchoring with standard bolts.
- Supplied with steel base plate and (optional) anchor bolts.
- Available in multiple mounting heights.
- Supplied with power cord (HAWG conductors).

VERSIONS (Click on below link to configure your product)

Model	Height	Width	Depth
SL4	18"	14"	14"
SL4-2	18"	14"	14"
SL5	18"	14"	14"
SL5-2	18"	14"	14"

6 BL-1 BOLLARD LIGHT
SCALE: N.T.S.

PLANTING:

- DURING CONSTRUCTION, PROTECT ALL EXISTING SITE FEATURES, STRUCTURES AND UTILITIES.
- PLANTS SHALL BE TRUE TO SPECIES AND VARIETY SPECIFIED AND NURSERY GROWN IN ACCORDANCE WITH THE AMERICAN STANDARD FOR NURSERY STOCK UNDER CLIMATIC CONDITIONS SIMILAR TO THOSE IN THE LOCALITY OF THE PROJECT. SUBSTITUTIONS WILL BE PERMITTED ONLY IF APPROVED BY THE LANDSCAPE ARCHITECT.
- LANDSCAPE ARCHITECT APPROVAL IS REQUIRED BEFORE PLANT MATERIAL IS PURCHASED. LANDSCAPE ARCHITECT RESERVES THE RIGHT TO SEE ALL MATERIAL IN PERSON AT THE NURSERY. IF TRAVEL OUTSIDE OF MA IS REQUIRED, LANDSCAPE ARCHITECT'S TRAVEL COSTS SHALL BE PAID FOR BY THE CONTRACTOR.
- ALL EXPOSED BURLAP, WIRE BASKETS AND OTHER MATERIALS ATTACHED TO PLANTS SHALL BE REMOVED PRIOR TO PLANTING. CARE SHALL BE TAKEN NOT TO DISTURB THE ROOT BALL OF PLANTS.
- THOROUGHLY WATER ALL PLANTS IMMEDIATELY AFTER PLANTING.
- WHERE DISCREPANCIES IN QUANTITIES OCCUR, DRAWINGS SUPERCEDE PLANT NOTES AND SCHEDULE.
- TRANSPLANTING SHALL BE DONE IN ACCORDANCE WITH THE AMERICAN STANDARD FOR NURSERY STOCK.
- LOAM USED IN PLANT BEDS SHALL BE UNIFORM IN COMPOSITION, FREE FROM SUBSOIL, STONES LARGER THAN 1", NOXIOUS SEEDS AND SUITABLE FOR THE SUPPORT OF VEGETATIVE GROWTH. THE pH VALUE SHALL BE BETWEEN 5.5 AND 6.5.
- MULCH IN TREE AND SHRUB BEDS SHALL BE NATURAL, NATIVE HEMLOCK MULCH FREE OF GROWTH OR GERMINATION INHIBITING INGREDIENTS. SUBMIT SAMPLES FOR APPROVAL.
- LOCATIONS FOR PLANTS AND/OR OUTLINE OF AREAS TO BE PLANTED ARE TO BE STAKED OUT AT THE SITE FOR APPROVAL BY THE LANDSCAPE ARCHITECT.
- SOIL DEPTHS: a.) SHRUBS AND PERENNIAL BEDS: 18" MIN.; b.) GROUNDCOVER: 6" MIN.; c.) TREES: PER CONSTRUCTION DETAIL; d.) SOD/SEED: 6" MIN.
- PROVIDE A SUBSURFACE ROOTBALL ANCHOR BY PLATIPUS EARTH ANCHORS, OR APPROVED EQUAL, SIZE FOR CALIPER AND HEIGHT.

NEW ENGLAND WETLAND PLANTS, INC

820 WEST STREET, AMHERST, MA 01002
PHONE: 413-548-8000 FAX 413-549-4000
EMAIL: INFO@NEWP.COM WEB ADDRESS: WWW.NEWP.COM

New England Conservation/Wildlife Mix

Botanical Name	Common Name	Indicator
<i>Elymus virginicus</i>	Virginia Wild Rye	FACW-
<i>Schizachyrium scoparium</i>	Little Bluestem	FACU
<i>Andropogon gerardii</i>	Big Bluestem	FAC
<i>Festuca rubra</i>	Red Fescue	FACU
<i>Sorghastrum nutans</i>	Indian Grass	UPL
<i>Panicum virgatum</i>	Switch Grass	FAC
<i>Chamaecrista fasciculata</i>	Partridge Pea	FACU
<i>Desmodium canadense</i>	Showy Tick Trefoil	FAC
<i>Asclepias tuberosa</i>	Butterfly Milkweed	NI
<i>Bidens frondosa</i>	Beggar Ticks	FACW
<i>Eupatorium purpureum (Eutrochium maculatum)</i>	Purple Joe Pye Weed	FAC
<i>Rudbeckia hirta</i>	Black Eyed Susan	FACU-
<i>Aster pilosus (Symphyotrichum pilosum)</i>	Heath (or Hairy) Aster	UPL
<i>Solidago juncea</i>	Early Goldenrod	FACU

PRICE PER LB. \$39.50 MIN. QUANTITY 2 LBS. TOTAL: \$79.00 APPLY: 25 LBS/ACRE :1750 sq ft/lb

The New England Conservation/Wildlife Mix provides a permanent cover of grasses, wildflowers, and legumes for both good erosion control and wildlife habitat value. The mix is designed to be a no maintenance seeding, and is appropriate for cut and fill slopes, detention basin side slopes, and disturbed areas adjacent to commercial and residential projects.

New England Wetland Plants, Inc. may modify seed mixes at any time depending upon seed availability. The design criteria and ecological function of the mix will remain unchanged. Price is 5/bulk pound, FOB warehouse, Plus SH and applicable taxes.

NOTE: NEW ENGLAND WETLAND PLANTS OR APPROVED EQUAL

7 MEADOW SEED MIX - NEW ENGLAND CONSERVATION/WILDLIFE MIX
SCALE: N.T.S.

NEW ENGLAND WETLAND PLANTS, INC

820 WEST STREET, AMHERST, MA 01002
PHONE: 413-548-8000 FAX 413-549-4000
EMAIL: INFO@NEWP.COM WEB ADDRESS: WWW.NEWP.COM

New England Wildflower Mix

Botanical Name	Common Name	Indicator
<i>Schizachyrium scoparium</i>	Little Bluestem	FACU
<i>Sorghastrum nutans</i>	Indian Grass	UPL
<i>Chamaecrista fasciculata</i>	Partridge Pea	FACU
<i>Elymus virginicus</i>	Virginia Wild Rye	FACW-
<i>Elymus canadensis</i>	Canada Wild Rye	FACU+
<i>Festuca rubra</i>	Red Fescue	FACU
<i>Asclepias tuberosa</i>	Butterfly Milkweed	NI
<i>Vernonia noveboracensis</i>	New York Ironweed	FACW+
<i>Oenothera biennis</i>	Evening Primrose	FACU-
<i>Aster novae-angliae (Symphyotrichum novae-angliae)</i>	New England Aster	FACW-
<i>Rudbeckia hirta</i>	Black Eyed Susan	FACU-
<i>Solidago juncea</i>	Early Goldenrod	FACU
<i>Eupatorium fistulosum (Eutrochium fistulosum)</i>	Hollow-Stem Joe Pye Weed	FACW
<i>Aster lateriflorus (Symphyotrichum lateriflorum)</i>	Starved/Calico Aster	FACW

PRICE PER LB. \$75.00 MIN. QUANTITY 1 LBS. TOTAL: \$75.00 APPLY: 23 LBS/ACRE :1900 sq ft/lb

New England Wetland Plants, Inc. may modify seed mixes at any time depending upon seed availability. The design criteria and ecological function of the mix will remain unchanged. Price is 5/bulk pound, FOB warehouse, Plus SH and applicable taxes.

NOTE: NEW ENGLAND WETLAND PLANTS OR APPROVED EQUAL

8 MEADOW SEED MIX - NEW ENGLAND WILDFLOWER MIX
SCALE: N.T.S.

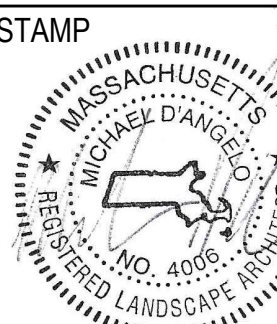

REV. NO.	DATE	DESCRIPTION
1	4/11/21	CC SUBMITTAL
2	10/21/22	CC RESUBMITTAL

LANDSCAPE
DETAILS

CHECKED	L9
SCALE	
AS NOTED	
DATE	
03/01/21	

NOT FOR CONSTRUCTION